

TANDEM plus BLUMOTION



New TANDEM plus BLUMOTION

Premium concealed runners for wood drawers

blum.com

Perfecting motion  **blum**[®]

A photograph of a modern kitchen interior. In the foreground, a light-colored wooden pull-out shelf is extended from a dark wood cabinet. The shelf is supported by a black metal track system. In the background, a stainless steel sink and a chrome faucet are visible. The overall aesthetic is clean and functional.

The next generation of TANDEM plus BLUMOTION



The right solution for every drawer

The new TANDEM plus BLUMOTION brings together all of the features, innovations and benefits that Blum has developed since first manufacturing drawer runners in the early 1960s. The first time you open and close a fully loaded drawer, you will quickly realize that TANDEM plus BLUMOTION is a runner system that is unmatched in quality, style and running action.

Contents

6	TANDEM plus BLUMOTION overview
7	Testing standards
8	General specifications
10	Using TANDEM plus BLUMOTION
12	Standard applications
22	Inset drawer
24	Narrow drawer
26	Lateral stabilizer for 563/569
28	Roll-out shelf
29	Bottom mount drawer
30	SPACE CORNER
32	Locking devices
34	Rear attachment options
36	Waste/recycle drawer with SERVO-DRIVE
38	Bottom mount drawer - heavy duty
40	TIP-ON for TANDEM plus
42	Accessories
44	Assembly aids
46	Additional options
47	Part number index

TANDEM plus BLUMOTION





Blum's newest generation of TANDEM plus BLUMOTION concealed drawer runners offers four-dimensional adjustment, elongated holes for depth adjustment, bottom mount holes and exceptional load capacity.

With TANDEM plus BLUMOTION concealed runners, the customer only sees the beauty of the wood drawers while experiencing the quality of motion and soft closing they have come to expect from Blum products.



TANDEM plus BLUMOTION concealed runners are made in the USA at our North Carolina facility. This is just one example of Blum's commitment to manufacturing in the US, for the US.

TANDEM plus BLUMOTION is mounted discreetly beneath the drawer and has the quietest opening and soft closing action available. This top-of-the-line concealed runner is the industry choice for dovetail drawers in high-end cabinetry, in either face frame or panel.

TANDEM plus BLUMOTION overview

drawer length	full extension		heavy duty full extension	
	maximum drawer thickness		maximum drawer thickness	
	5/8"	3/4"	5/8"	3/4"
9"	563H series	563F series		
12"				
15"				
18"	563H and 563. series		569H series	569F series
21"				
24"			569. series	569A series
27"				
30"				
capacity static/dynamic	100/90 lb*		150/135 lb*	

*Per ANSI/BHMA 156.9 Grade 1 standards on a 21" length drawer box

Standard lengths

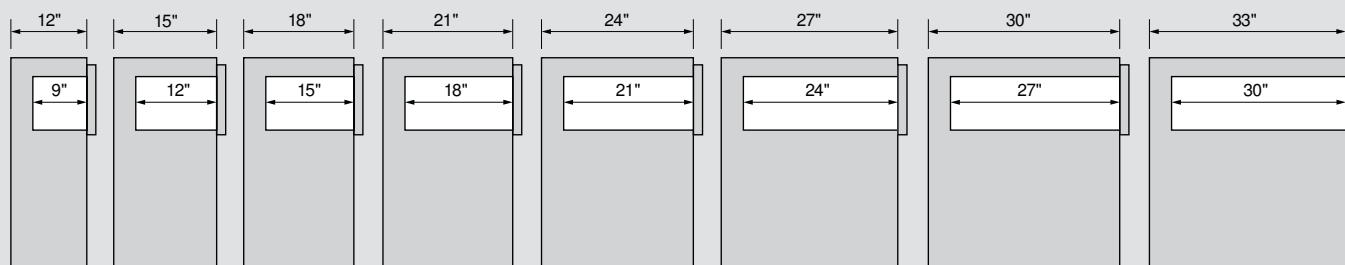

TANDEM series runners are based on the American standard 3" cabinet depth system, therefore runner lengths are in 3" increments. TANDEM plus runners are available for drawers from 9" to 30" in length.



Planning tools

Blum has downloadable Excel® spreadsheets that provide the required parts and calculate the mounting locations for your application.

Planning tools are easily accessible on our website at blum.com/planning





ISO 9001

Blum, Inc. is ISO 9001 certified which means that you are assured of consistent quality in every Blum product.



ANSI/BHMA

All Blum runners meet or exceed ANSI/BHMA 156.9 Grade 1 requirements. Contact your local Blum representative for more details.



General information

All Blum hardware undergoes strict quality control procedures through all stages of production. Blum hardware is designed for cabinets and cabinet components made from wood, melamine or MDF. Careful attention must be paid to installation and operating instructions when using Blum hardware (see catalogs and instruction sheets for all technical information). The manufacturer must decide on the screws or attachment methods to suit the material being used (i.e. wood, melamine, etc.). The hardware must not be exposed to acidic or corrosive materials (i.e. some household cleaning solutions). To ensure that Blum hardware functions correctly, it must be kept clean and undamaged. For any additional information please contact your Blum representative. Anyone selling Blum hardware must ensure that their customer is aware of any relevant information given in this catalog.

Conditions of sale and delivery

All deliveries and services are based on the "general conditions of sale" which are available upon request. The technical presentations and dimensions in illustrations are non-binding. We reserve the right to make changes to specifications at any time. We do not accept any responsibility for any errors which may occur in the production of this catalog.

General specifications

Complete runner system

- Full extension concealed runners with BLUMOTION soft close
- Zinc-coated steel
- Concealed roller carriage with permanently lubricated synthetic rollers
- Available in standard and heavy duty
- H and . series for drawers up to 5/8" side material thickness
- F and A series for drawers up to 3/4" side material thickness
- Elongated holes for depth adjustment
- Bottom mount holes on 15", 18" and 21" standard duty
- Tool-free tilt adjustment
- Tool-free rear side-to-side adjustment

Locking devices

- Stamped steel or zinc die-cast base with synthetic, spring-loaded release levers
- Captive right device, self-aligning left device
- Self-adjusting drawer length tolerance
- Tool-free height adjustment
- Tool-free front side-to-side adjustment
- Available with depth adjustment
- Available for narrow drawers

Rear mounting options

- Zinc-coated steel brackets or nylon sockets
- Depth and lateral self-alignment

One runner for all applications

TANDEM runners are designed for the American 3" increment cabinet depth system. This feature permits overlay or inset applications to use the same runner. Full length runners make installation in panel or face frame cabinets possible.

Load capacities

- 100 lb static, 90 lb dynamic for TANDEM plus BLUMOTION 563 series
- 150 lb static, 135 lb dynamic for TANDEM plus BLUMOTION 569 series

Drawer components

NOTE: For 563. and 569 series, rear brackets and sockets cannot be used. Cabinet sides must be blocked-out flush with the inside of the face frame.

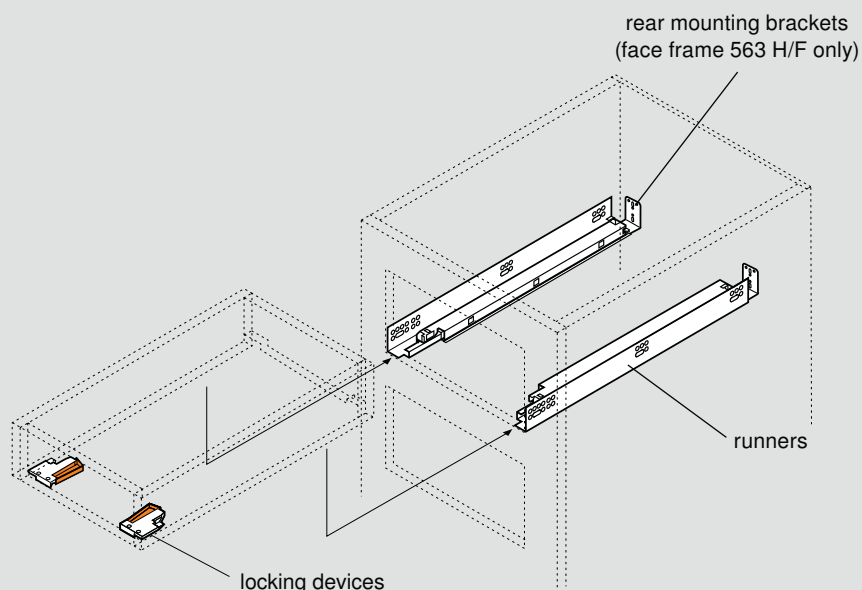

NOTE: Rear mounting brackets used for frame applications only

Locking devices

Locking devices allow easy insertion and removal of drawers



page 32

Rear mounting options

For use when installing TANDEM runners in face frame cabinets. Not necessary for panel cabinet installation.



page 34

Accessories



page 42

TANDEM template

A required assembly aid for the boring of TANDEM locking devices and rear hooks



page 44

New side adjustment

- 1 Rotate side adjustment left or right equally on both locking devices. Drawer front moves in the same direction as rotation.

T51.1901.xx with side adjustment

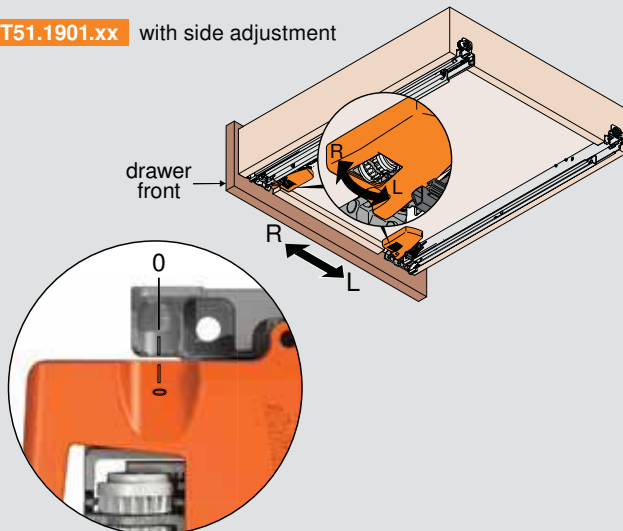

Maximum 1.5 (1/16") to left or right (tool-free)

NOTE: Side adjustment not available on T51.x8xx locking devices

New rear side adjustment

- 2 After front side adjustment is made with the locking devices, rotate the rear side adjustment left or right to re-align the back of the drawer box with the front. Drawer back moves in the same direction as rotation.

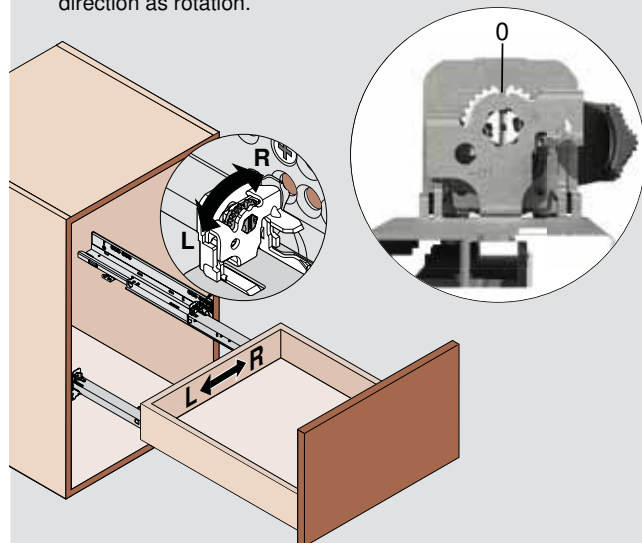

Maximum 1.5 (1/16") to left or right (tool-free)

New depth adjustable locking device

Locking device

T51.1901.PS
with side, height and depth adjustment

Turning the adjustment screw allows for up to 2.5 (3/32") out adjustment

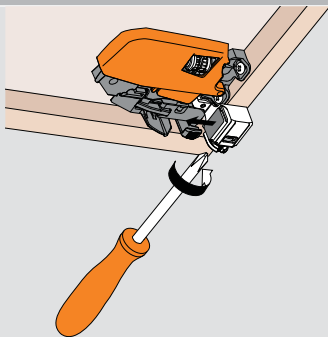

page 32

New depth adjustment on runner

TANDEM 563 and 569 runners feature elongated holes that allow ± 4.5 (3/16") depth adjustment

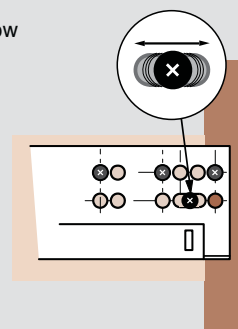

Height adjustment

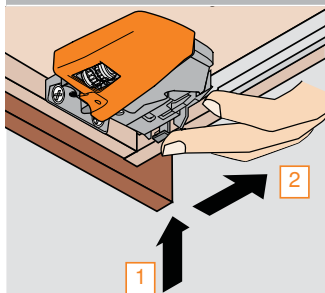

- 1 Press up on adjustment tab
- 2 Push towards back of drawer

Maximum 3 (1/8") rise of drawer front (tool-free)

NOTE: Height adjustment available on all TANDEM locking devices

Tilt adjustment

Rotate the tilt adjustment lever on the rear of each runner to tilt the top of the drawer front forward

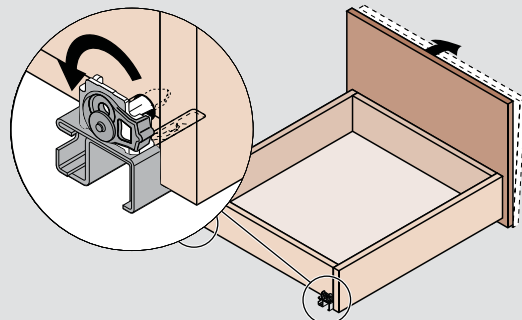

Maximum 5 (3/16") rise of drawer back (tool-free)

Using TANDEM plus BLUMOTION

Step 1

Measure cabinet opening

Cabinet opening measurements are needed to determine drawer box size.

Panel cabinet

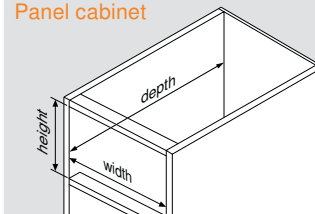

Frame cabinet

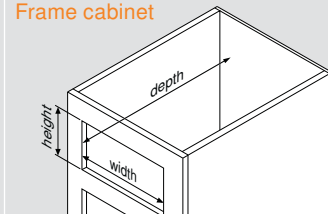

Step 2

Select TANDEM runners

Based on the application, choose the TANDEM runner that fits the desired extension, drawer side thickness, load capacity and cabinet depth. Then go to the corresponding catalog page for more specific information.

drawer length	full extension		heavy duty full extension	
	maximum drawer thickness		maximum drawer thickness	
	5/8"	3/4"	5/8"	3/4"
9"				
12"	563H series	563F series		
15"				
18"	563H and 563 series		569H series	569F series
21"				
24"			569 series	569A series
27"				
30"				
capacity static/dynamic	100/90 lb*		150/135 lb*	

Step 3

Preparing drawer boxes

Build drawers according to the specifications given for the TANDEM runners you chose and the measurements determined in Step 1. Install appropriate locking devices and bore holes to accept rear hooks.

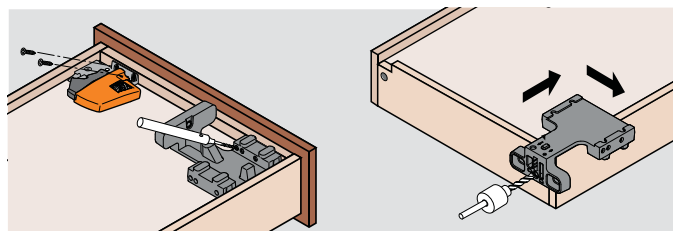

Step 4

Attach runners to cabinet

Using the mounting information given for the TANDEM runners you chose, mount the TANDEM runners in the cabinet.

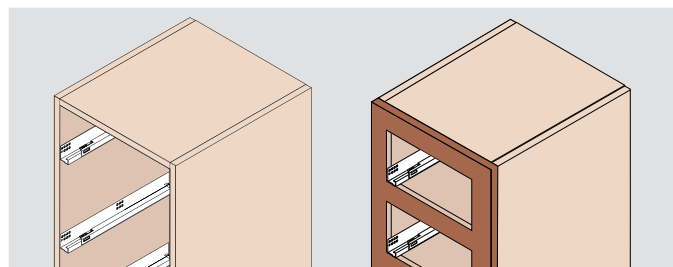

Step 5

Insert drawers

Extend the drawer runners fully. Place the drawer on the runners and close. The locking devices automatically engage with the runners. Make adjustments if necessary.

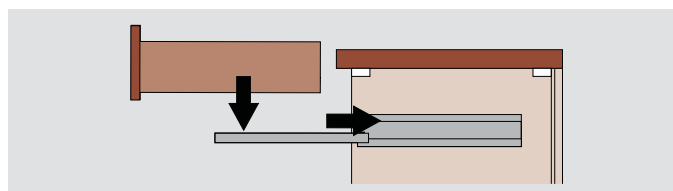

Step 6

Drawer removal

Squeeze orange handles on locking devices and pull drawer straight out and up.

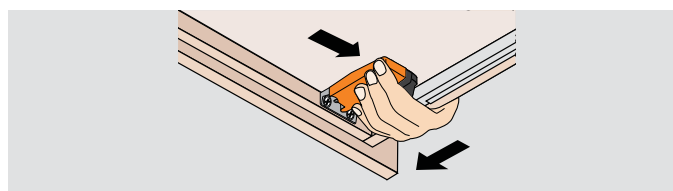

Drawer preparation



Rear notching

Dimensions

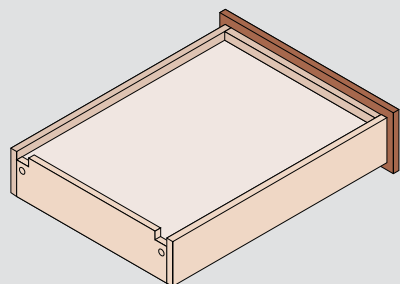

Drawers must be notched in the back to accommodate TANDEM runners

Rear view

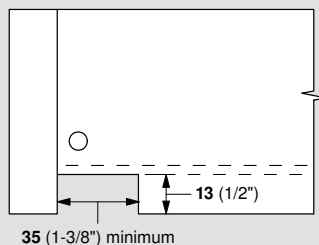

The notches must be flush with the drawer sides and bottom

NOTE: TIP-ON for TANDEM plus requires **85** (3-11/32") notch

page 40

Option – no notching

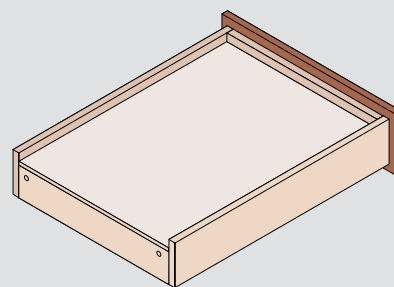

Make the back panel shorter and extend the drawer bottom to the back of the drawer

Rear boring

Dimensions

Rear view

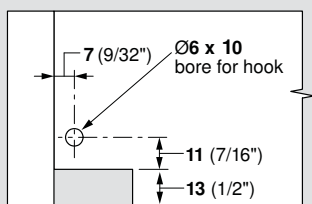

Drawers require 6 mm holes bored on each side of the back panel to accept the hooks on the back of TANDEM runners

Boring

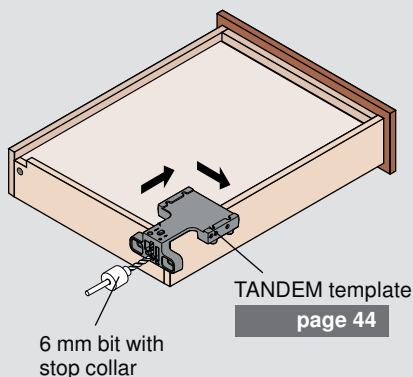

- 1 Place template over the drawer side
- 2 Position template so that the center rib rests against the inside face of the drawer side
- 3 Set stop collar on 6 mm bit so that it will bore **10** (13/32") deep
- 4 Hold template firmly and bore hole
- 5 Repeat on other side

page 44

NOTE: Using the **T65.1600.01** TANDEM template is highly recommended

Locking devices

Installation

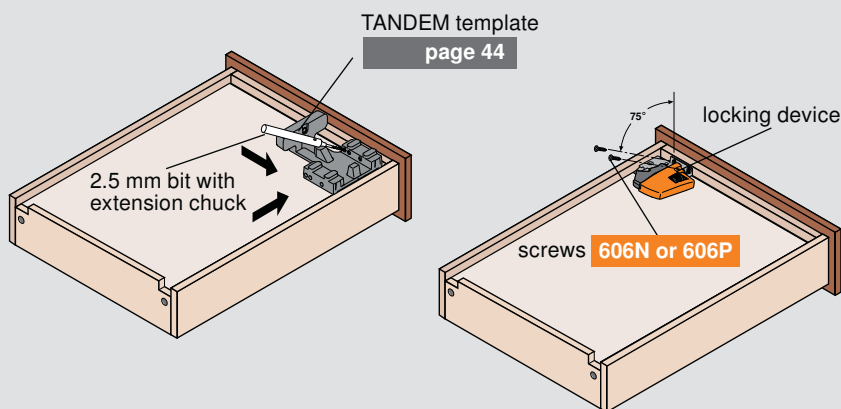

- 1 Position the 2.5 mm drill bit into the extension chuck so that it will bore **10** (13/32") deep
- 2 Place template into the front corner of the drawer
- 3 Bore two holes and repeat on other side
- 4 Attach locking devices with #6 x 5/8" deep thread wood screws (606N or 606P)

NOTE: The mounting screws must go in at a precise angle and the locking device must fit flush to the drawer bottom to ensure proper function of the complete drawer system

NOTE: Using the **T65.1600.01** TANDEM template is highly recommended

TANDEM plus BLUMOTION 563.

Application



New features

- Four-dimensional adjustment
- Elongated holes for depth adjustment
- Bottom mount holes
- 100 lb static load capacity

Description

- Full extension concealed drawer runners
- Panel or blocked-out face frame cabinets
- BLUMOTION soft closing
- TANDEM smooth running action
- Available in 18" and 21" lengths
- 13 (1/2") to 16 (5/8") drawer thickness
- Made in the USA

Basic components

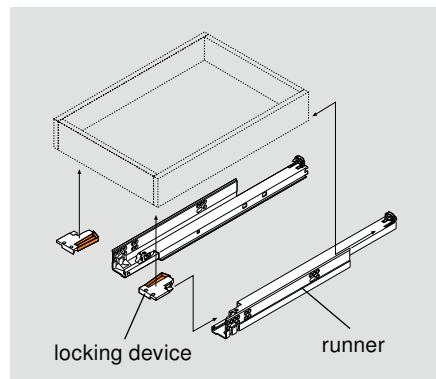

Other applications



Inset drawer pg 22



Narrow drawer pg 24



Roll-out shelf pg 28



Bottom mount pg 29

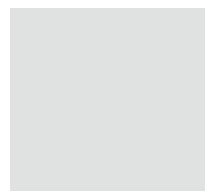
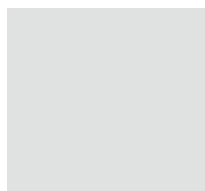

Components

Runner set

One set required per drawer



for overall cabinet depth	drawer length	TANDEM plus BLUMOTION
610 (24")	533 (21")	563.5330B
533 (21")	457 (18")	563.4570B
Wood screw for installation		606N or 606P
System screw for installation		662.1150.HG

Side adjustable locking device



- One right and one left required per drawer
- With side-to-side adjustment
- Captive right and self-aligning left device
- Self-adjusting drawer length tolerance
- Steel base with synthetic, spring-loaded release levers
- Minimum inside drawer width 170 (6-11/16")
- Height adjustment +3 (1/8")
- Side adjustment ±1.5 (1/16")
- For use with 563/569 series runners only
- For other options see page 32

Part no.

Right locking device T51.1901 R

Left locking device T51.1901 L

Installation screw 606N or 606P

page 11

NOTE: For 563. series runners, rear brackets and sockets cannot be used. Cabinet sides must be blocked-out flush with the inside of the frame. See page 13.

Using TANDEM

page 10

Drawer preparation

page 11

Accessories

page 42

Assembly aids

page 44

Drawer and cabinet specifications

Maximum drawer thickness	16 (5/8")
Lengths available	18" - 21"
Static load capacity	100 lb

Drawer box specifications

Front view

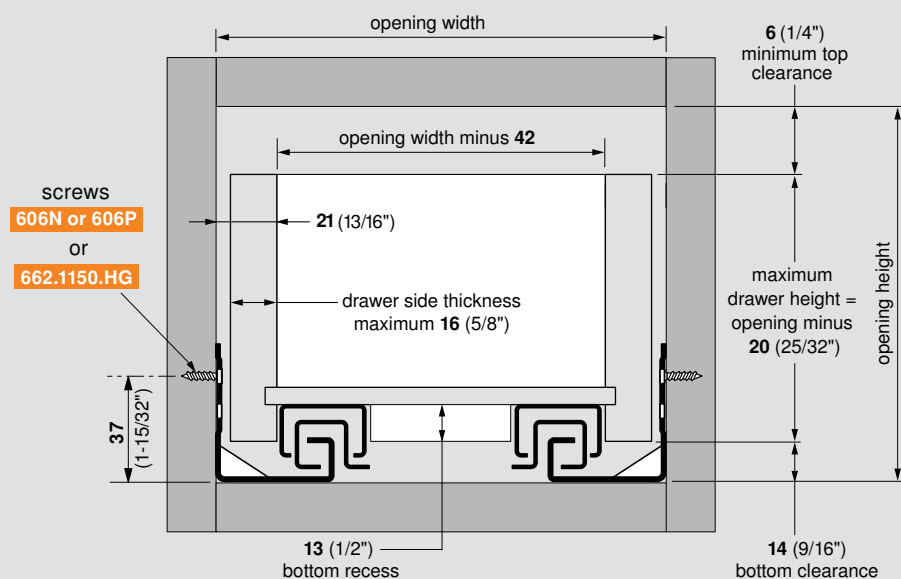

NOTE: Material thickness may vary. Inside drawer width **must** equal opening width minus 42 for TANDEM to align and function properly.

Drawer back preparation

Rear view

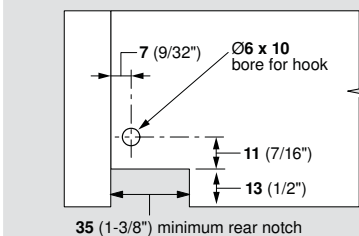

Runner comparison

Side view

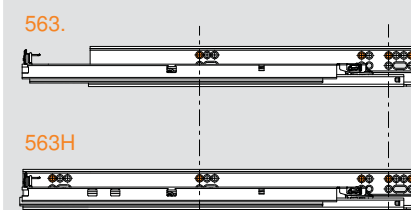

NOTE: Same hole pattern as the 563H

Runner mounting specifications

Side view

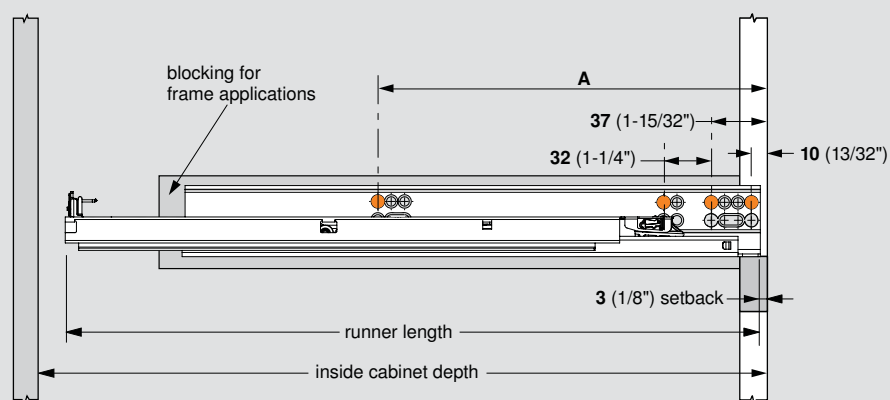

NOTE: The orange dots indicate fixing screw locations required to meet specified load ratings

TANDEM plus BLUMOTION	drawer length	minimum inside cabinet depth	runner length	screw location
563.5330B	533 (21")	557 (21-15/16")	548 (21-9/16")	261 (10-9/32")
563.4570B	457 (18")	480 (18-29/32")	471 (18-17/32")	261 (10-9/32")

Runner close-up

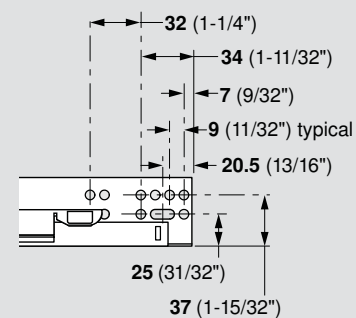

NOTE: Elongated holes are for ±4.5 (3/16") depth adjustment only. Additional screws must be used to secure the runner to the cabinet.

TANDEM plus BLUMOTION 563H

Application

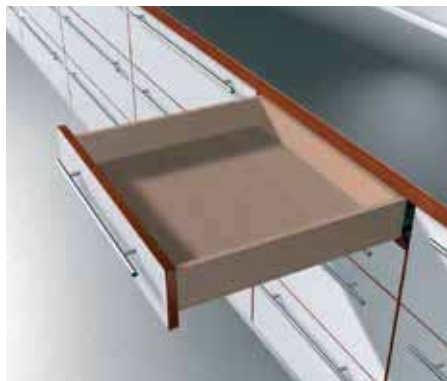

New features

- Four-dimensional adjustment
- Elongated holes for depth adjustment
- Bottom mount holes on 15", 18" and 21"
- 100 lb static load capacity

Description

- Full extension concealed drawer runners
- Face frame or panel cabinets
- BLUMOTION soft closing
- TANDEM smooth running action
- Available in 9" to 21" lengths
- 13 (1/2") to 16 (5/8") drawer thickness
- Made in the USA

Basic components

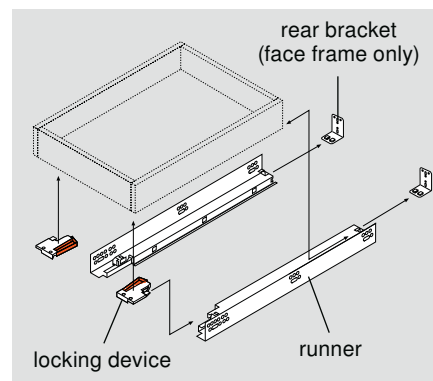

Other applications



Inset drawer pg 22



Narrow drawer pg 24



Roll-out shelf pg 28



Bottom mount pg 29

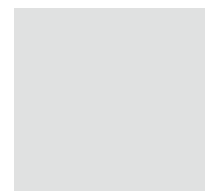
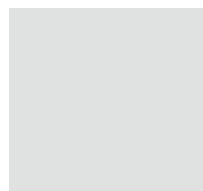

Components

Runner set

One set required per drawer



for overall cabinet depth	drawer length	TANDEM plus BLUMOTION
610 (24")	533 (21")	563H5330B
533 (21")	457 (18")	563H4570B
457 (18")	381 (15")	563H3810B
381 (15")	305 (12")	563H3050B
305 (12")	229 (9")	563H2290B10
Wood screw for installation		606N or 606P
System screw for installation		662.1150.HG

Side adjustable locking device



- One right and one left required per drawer
- With side-to-side adjustment
- Captive right and self-aligning left device
- Self-adjusting drawer length tolerance
- Steel base with synthetic, spring-loaded release levers
- Minimum inside drawer width 170 (6-11/16")
- Height adjustment +3 (1/8")
- Side adjustment ±1.5 (1/16")
- For use with 563/569 series runners only
- For other options see page 32

Part no.

Right locking device T51.1901 R

Installation Left locking device T51.1901 L

page 11 Installation screw 606N or 606P

Rear mounting bracket for frame cabinets



For use when installing TANDEM runners in face frame cabinets. Not necessary for panel cabinet installation.

- Two required per drawer
- Depth and lateral self-alignment
- Zinc-coated steel
- For 9" TANDEM rear attachment options see page 35

Part no.

Non-handed bracket 295.3750.01

Installation screw 606N or 606P

Using TANDEM

page 10

Drawer preparation

page 11

Accessories

page 42

Assembly aids

page 44

Drawer and cabinet specifications

Maximum drawer thickness	16 (5/8")
Lengths available	9" - 21"
Static load capacity	100 lb

Drawer box specifications

Front view

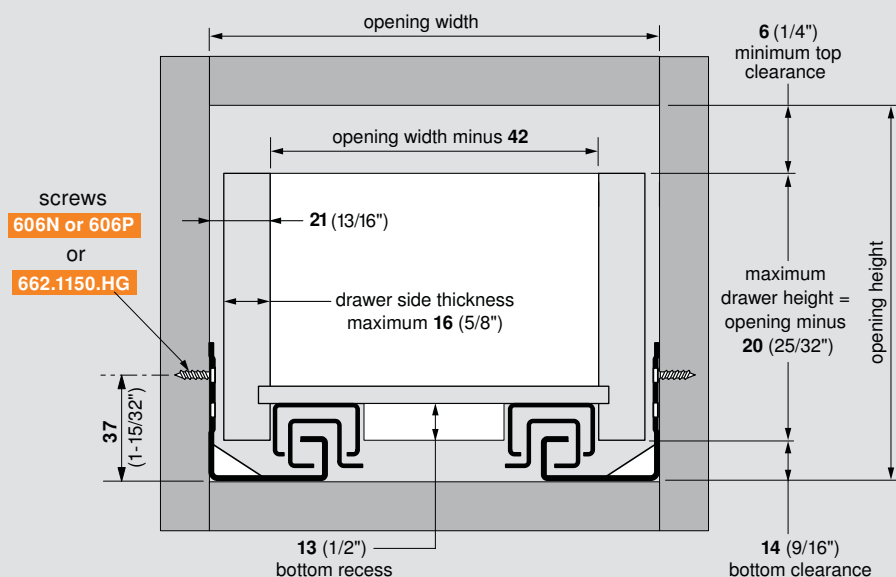

NOTE: Material thickness may vary. Inside drawer width **must** equal opening width minus 42 for TANDEM to align and function properly.

Drawer back preparation

Rear view

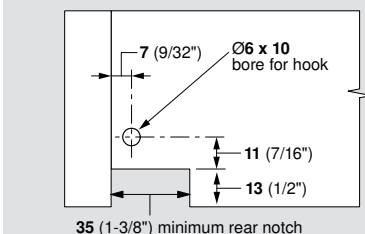

Rear mounting bracket

Front view

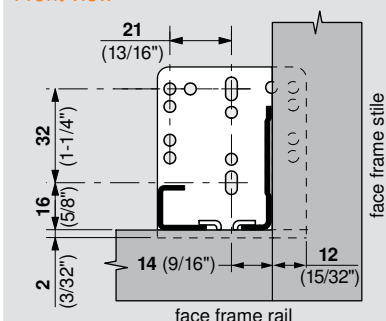

NOTE: For frame applications, use a minimum of three screws per bracket

Runner mounting specifications

Side view

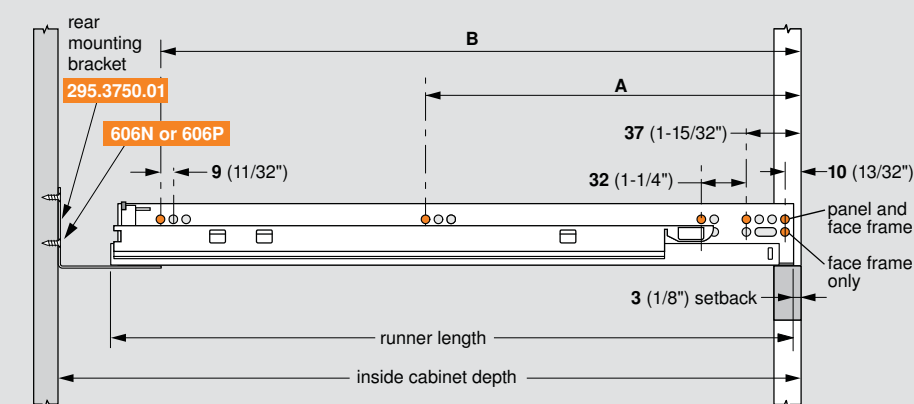

NOTE: The orange dots indicate fixing screw locations required to meet specified load ratings

Runner close-up

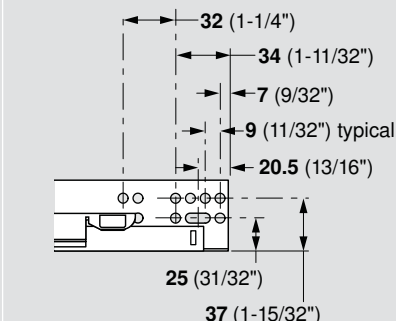

NOTE: Elongated holes are for ±4.5 (3/16") depth adjustment only. Additional screws must be used to secure the runner to the cabinet.

TANDEM plus BLUMOTION	drawer length	inside cabinet depth with rear attachment		runner length	screw locations for panel cabinets	
		maximum	minimum		A	B
563H5330B	533 (21")	599 (23-19/32")	557 (21-15/16")	548 (21-9/16")	261 (10-9/32")	517 (20-11/32")
563H4570B	457 (18")	522 (20-9/16")	480 (18-29/32")	471 (18-17/32")	261 (10-9/32")	453 (17-27/32")
563H3810B	381 (15")	446 (17-9/16")	404 (15-29/32")	395 (15-9/16")	165 (6-1/2")	357 (14-1/16")
563H3050B	305 (12")	370 (14-9/16")	328 (12-29/32")	319 (12-9/16")	165 (6-1/2")	261 (10-9/32")
563H2290B10	229 (9")	299 (11-25/32")	266 (10-15/32")	259 (10-3/16")	133 (5-1/4")	229 (9")

TANDEM plus BLUMOTION 563F

Application



New features

- Four-dimensional adjustment
- Elongated holes for depth adjustment
- Bottom mount holes on 15", 18" and 21"
- 100 lb static load capacity

Description

- Full extension concealed drawer runners
- Face frame or panel cabinets
- BLUMOTION soft closing
- TANDEM smooth running action
- Available in 9" to 21" lengths
- 16 (5/8") to 19 (3/4") drawer thickness
- Made in the USA

Basic components

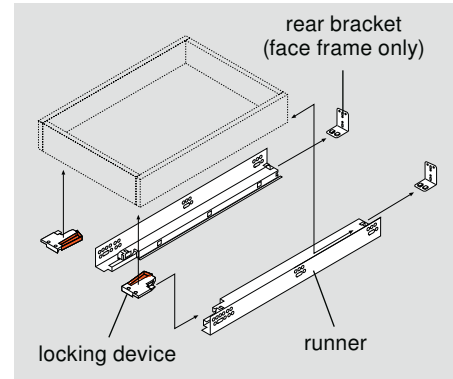

Other applications

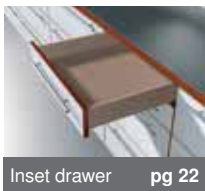

Inset drawer pg 22



Narrow drawer pg 24



Roll-out shelf pg 28



Bottom mount pg 29

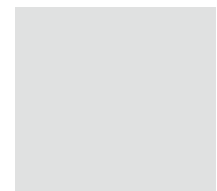
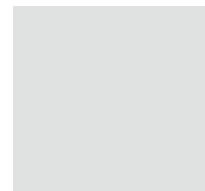

Components

Runner set

One set required per drawer



for overall cabinet depth	drawer length	TANDEM plus BLUMOTION
610 (24")	533 (21")	563F5330B
533 (21")	457 (18")	563F4570B
457 (18")	381 (15")	563F3810B
381 (15")	305 (12")	563F3050B
305 (12")	229 (9")	563F2290B10
Wood screw for installation		606N or 606P
System screw for installation		662.1150.HG

Side adjustable locking device



- One right and one left required per drawer
- With side-to-side adjustment
- Captive right and self-aligning left device
- Self-adjusting drawer length tolerance
- Steel base with synthetic, spring-loaded release levers
- Minimum inside drawer width 170 (6-11/16")
- Height adjustment +3 (1/8")
- Side adjustment ±1.5 (1/16")
- For use with 563/569 series runners only
- For other options see page 32

Part no.

Right locking device **T51.1901 R**

Installation Left locking device **T51.1901 L**

page 11 Installation screw **606N or 606P**

Rear mounting bracket for frame cabinets



For use when installing TANDEM runners in face frame cabinets. Not necessary for panel cabinet installation.

- Two required per drawer
- Depth and lateral self-alignment
- Zinc-coated steel
- For 9" TANDEM rear attachment options see page 35

Part no.

Non-handed bracket **295.3750.01**

Installation screw **606N or 606P**

Using TANDEM page 10

Drawer preparation page 11

Accessories page 42

Assembly aids page 44

Drawer and cabinet specifications

Maximum drawer thickness	19 (3/4")
Lengths available	9" - 21"
Static load capacity	100 lb

Drawer box specifications

Front view

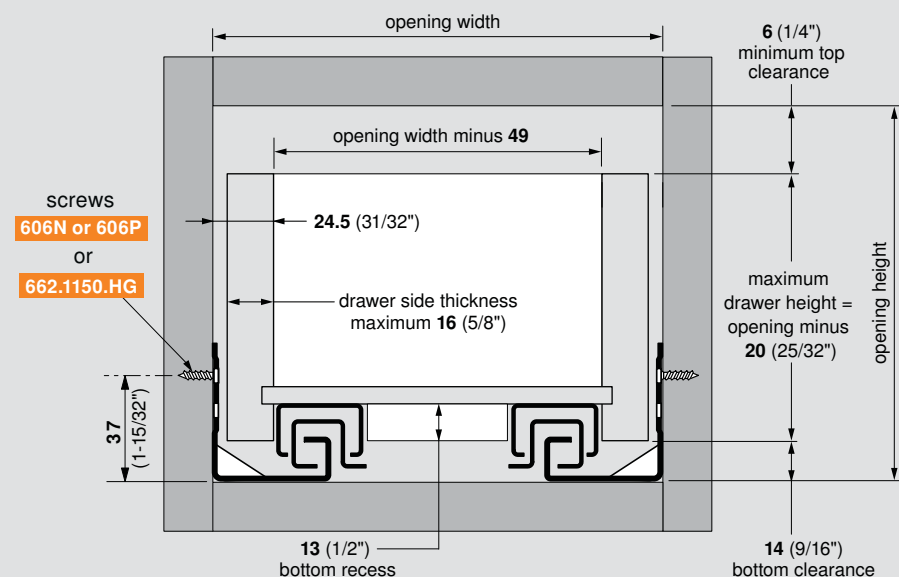

NOTE: Material thickness may vary. Inside drawer width **must** equal opening width minus 49 for TANDEM to align and function properly.

Drawer back preparation

Rear view

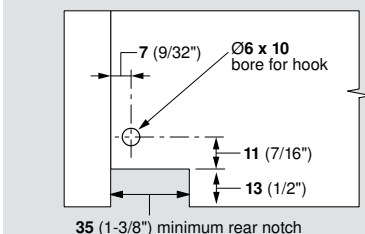

Rear mounting bracket

Front view

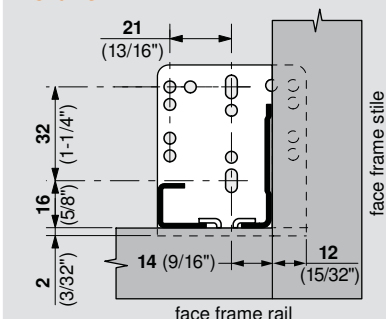

NOTE: For frame applications, use a minimum of three screws per bracket

Runner mounting specifications

Side view

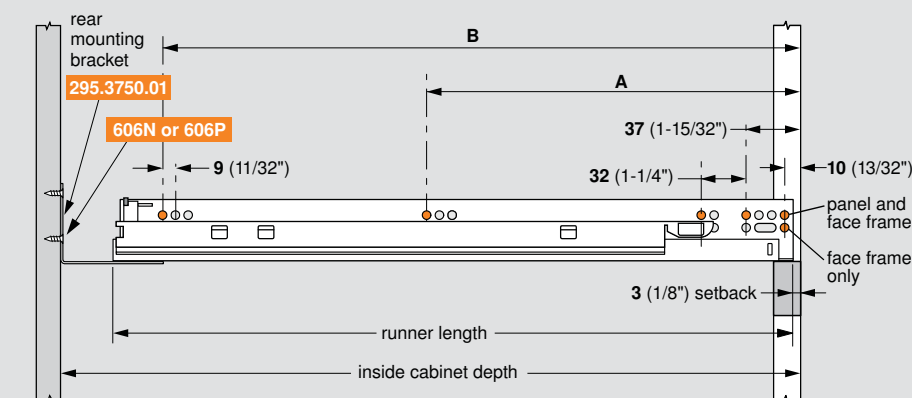

NOTE: The orange dots indicate fixing screw locations required to meet specified load ratings

Runner close-up

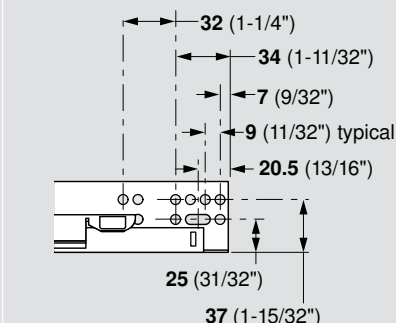

NOTE: Elongated holes are for ±4.5 (3/16") depth adjustment only. Additional screws must be used to secure the runner to the cabinet.

TANDEM plus BLUMOTION	drawer length	inside cabinet depth with rear attachment		runner length	screw locations for panel cabinets	
		maximum	minimum		A	B
563F5330B	533 (21")	599 (23-19/32")	557 (21-15/16")	548 (21-9/16")	261 (10-9/32")	517 (20-11/32")
563F4570B	457 (18")	522 (20-9/16")	480 (18-29/32")	471 (18-17/32")	261 (10-9/32")	453 (17-27/32")
563F3810B	381 (15")	446 (17-9/16")	404 (15-29/32")	395 (15-9/16")	165 (6-1/2")	357 (14-1/16")
563F3050B	305 (12")	370 (14-9/16")	328 (12-29/32")	319 (12-9/16")	165 (6-1/2")	261 (10-9/32")
563F2290B10	229 (9")	299 (11-25/32")	266 (10-15/32")	259 (10-3/16")	133 (5-1/4")	229 (9")

TANDEM plus BLUMOTION 569H/569. heavy duty

Application



New features

- Four-dimensional adjustment
- Elongated holes for depth adjustment
- 150 lb static load capacity

Description

- Full extension concealed drawer runners
- Panel or blocked-out face frame cabinets
- BLUMOTION soft closing
- TANDEM smooth running action
- Available in 18" to 30" lengths
- 13 (1/2") to 16 (5/8") drawer thickness

Basic components

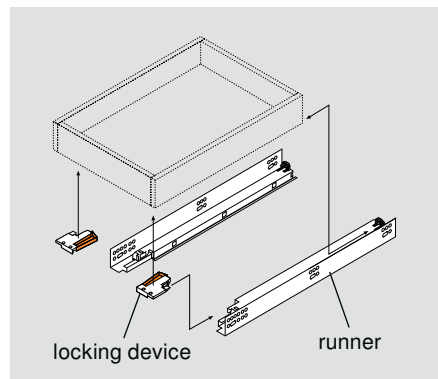

Other applications



Inset drawer pg 22



SPACE CORNER pg 30

Components

Runner set

One set required per drawer



for overall cabinet depth	drawer length	TANDEM plus BLUMOTION
838 (33")	762 (30")	569.7620B
762 (30")	686 (27")	569.6860B
686 (27")	610 (24")	569.6100B
610 (24")	533 (21")	569H5330B
533 (21")	457 (18")	569H4570B
Wood screw for installation		606N or 606P
System screw for installation		662.1150.HG

Side adjustable locking device



- One right and one left required per drawer
- With side-to-side adjustment
- Captive right and self-aligning left device
- Self-adjusting drawer length tolerance
- Steel base with synthetic, spring-loaded release levers
- Minimum inside drawer width 170 (6-11/16")
- Height adjustment +3 (1/8")
- Side adjustment ±1.5 (1/16")
- For use with 563/569 series runners only
- For other options see page 32

Part no.

Right locking device T51.1901 R

Left locking device T51.1901 L

Installation screw 606N or 606P

page 11

NOTE: For heavy duty applications, rear brackets and sockets cannot be used. Cabinet sides must be blocked-out flush with the inside of the frame. See page 19.

Using TANDEM

page 10

Drawer preparation

page 11

Accessories

page 42

Assembly aids

page 44

Drawer and cabinet specifications

Maximum drawer thickness	16 (5/8")
Lengths available	18" - 30"
Static load capacity	150 lb

Drawer box specifications

Front view

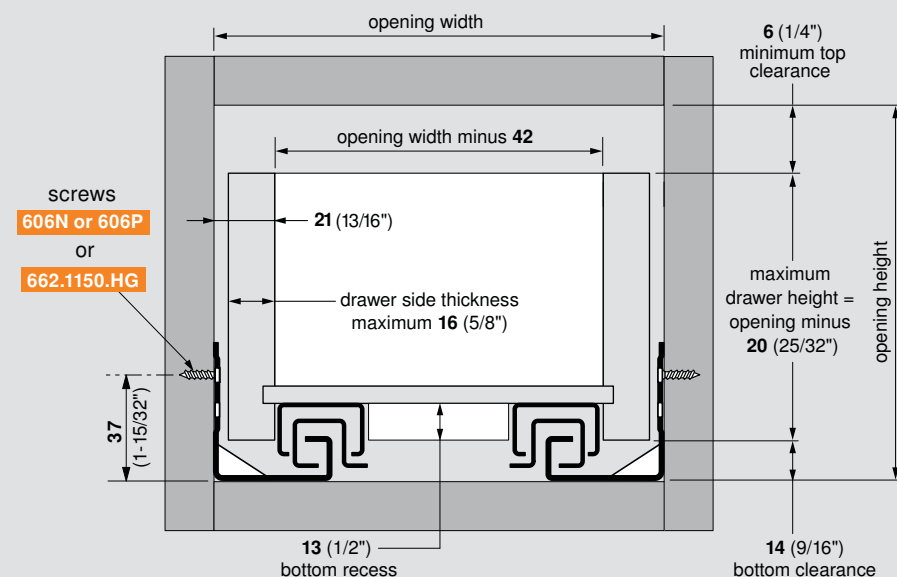

NOTE: Material thickness may vary. Inside drawer width **must** equal opening width minus 42 for TANDEM to align and function properly.

Drawer back preparation

Rear view

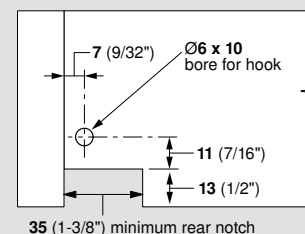

Runner comparison

Side view

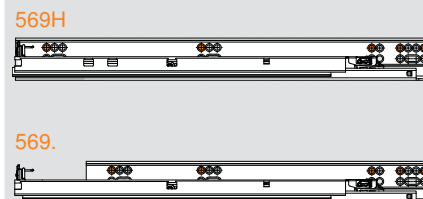

Runner mounting specifications

Side view

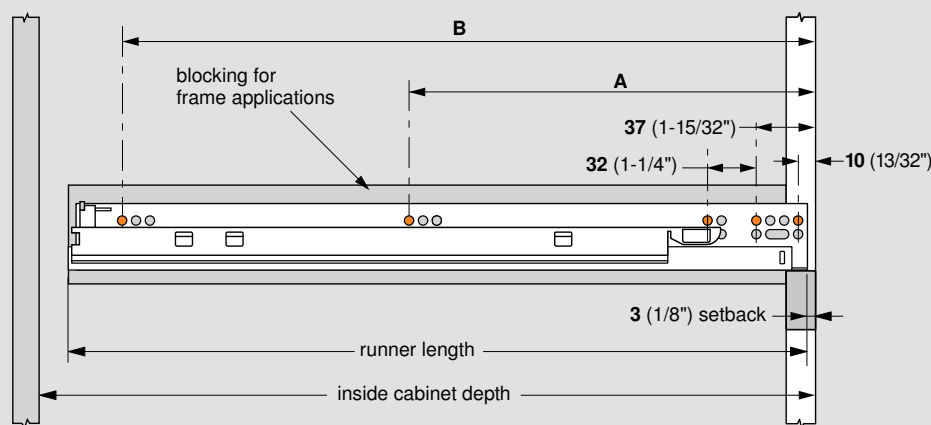

NOTE: The orange dots indicate fixing screw locations required to meet specified load ratings

Runner close-up

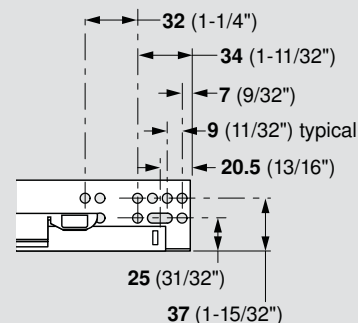

NOTE: Elongated holes are for ±4.5 (3/16") depth adjustment only. Additional screws must be used to secure the runner to the cabinet.

TANDEM plus BLUMOTION	drawer length	minimum inside cabinet depth	runner length	screw locations	
				A	B
569.7620B	762 (30")	786 (30-15/16")	777 (30-19/32")	261 (10-9/32")	389 (15-5/16")
569.6860B	686 (27")	709 (27-29/32")	700 (27-9/16")	261 (10-9/32")	389 (15-5/16")
569.6100B	610 (24")	634 (24-31/32")	625 (24-19/32")	261 (10-9/32")	389 (15-5/16")
569H5330B	533 (21")	557 (21-15/16")	548 (21-9/16")	261 (10-9/32")	517 (20-11/32")
569H4570B	457 (18")	480 (18-29/32")	471 (18-17/32")	261 (10-9/32")	453 (17-27/32")

TANDEM plus BLUMOTION 569F/569A heavy duty

Application

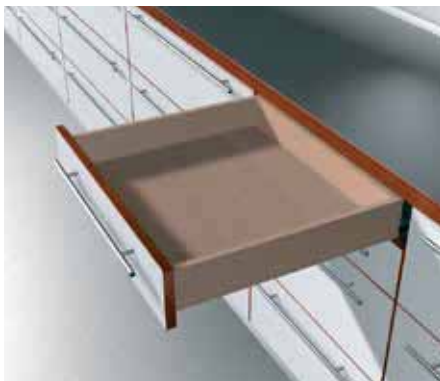

New features

- Four-dimensional adjustment
- Elongated holes for depth adjustment
- 150 lb static load capacity

Description

- Full extension concealed drawer runners
- Panel or blocked-out face frame cabinets
- BLUMOTION soft closing
- TANDEM smooth running action
- Available in 18" to 30" lengths
- 16 (5/8") to 19 (3/4") drawer thickness

Basic components

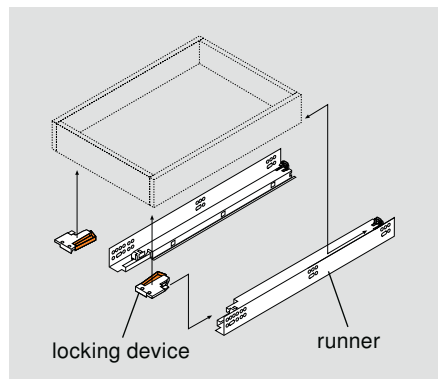

Other applications

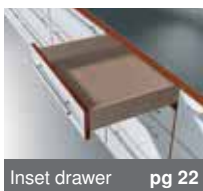

Inset drawer pg 22



SPACE CORNER pg 30

Components

Runner set

One set required per drawer



for overall cabinet depth	drawer length	TANDEM plus BLUMOTION
838 (33")	762 (30")	569A7620B
762 (30")	686 (27")	569A6860B
686 (27")	610 (24")	569A6100B
610 (24")	533 (21")	569F5330B
533 (21")	457 (18")	569F4570B
Wood screw for installation		606N or 606P
System screw for installation		662.1150.HG

Side adjustable locking device



- One right and one left required per drawer
- With side-to-side adjustment
- Captive right and self-aligning left device
- Self-adjusting drawer length tolerance
- Steel base with synthetic, spring-loaded release levers
- Minimum inside drawer width 170 (6-11/16")
- Height adjustment +3 (1/8")
- Side adjustment ±1.5 (1/16")
- For use with 563/569 series runners only
- For other options see page 32

Part no.

Right locking device T51.1901 R

Left locking device T51.1901 L

page 11

Installation screw 606N or 606P

NOTE: For heavy duty applications, rear brackets and sockets cannot be used. Cabinet sides must be blocked-out flush with the inside of the frame. See page 21.

Using TANDEM

page 10

Drawer preparation

page 11

Accessories

page 42

Assembly aids

page 44

Drawer and cabinet specifications

Maximum drawer thickness	19 (3/4")
Lengths available	18" - 30"
Static load capacity	150 lb

Drawer box specifications

Front view

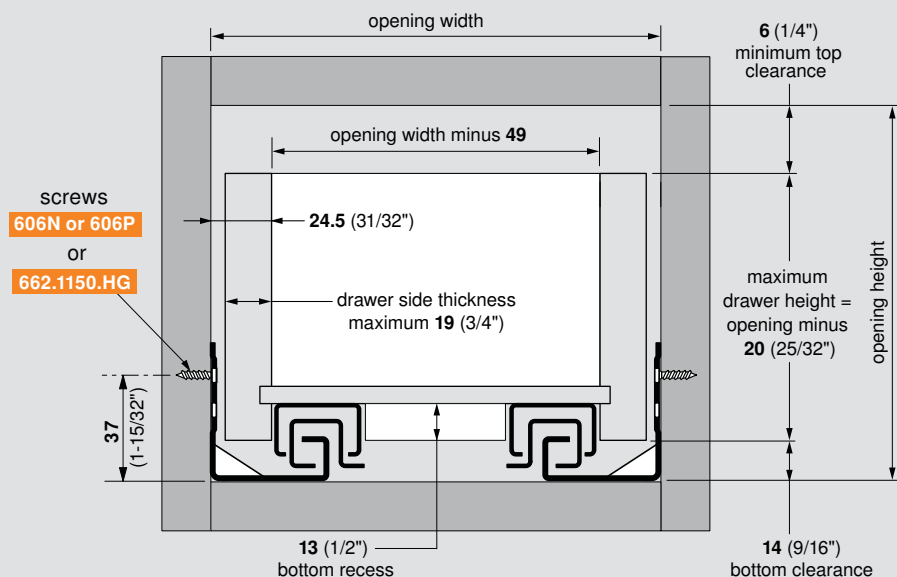

NOTE: Material thickness may vary. Inside drawer width **must** equal opening width minus 49 for TANDEM to align and function properly.

Drawer back preparation

Rear view

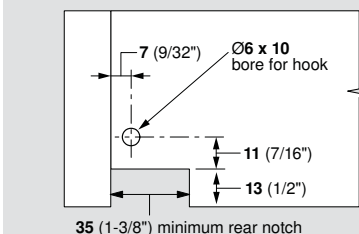

Runner comparison

Side view

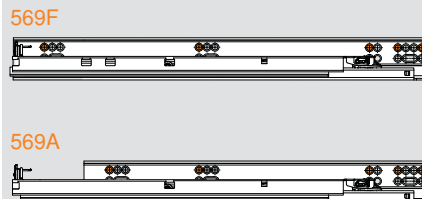

Runner mounting specifications

Side view

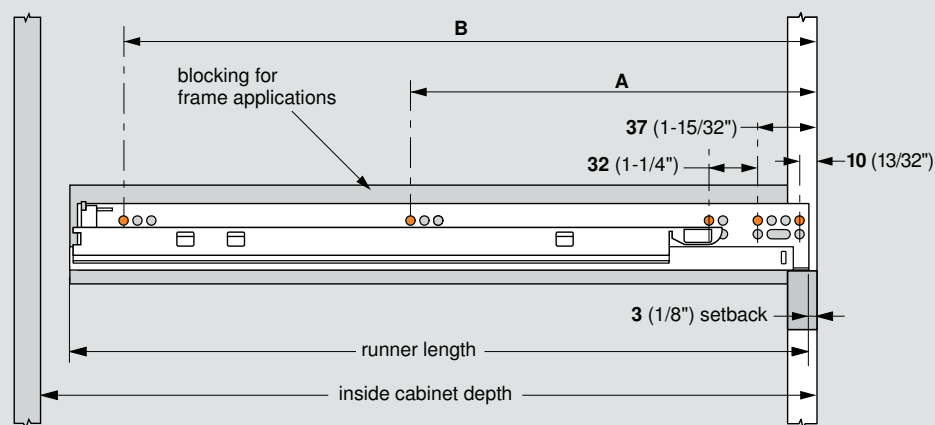

Runner close-up

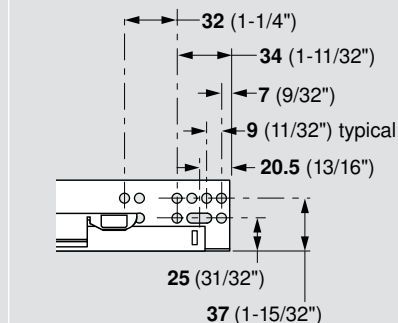

NOTE: Elongated holes are for ±4.5 (3/16") depth adjustment only. Additional screws must be used to secure the runner to the cabinet.

NOTE: The orange dots indicate fixing screw locations required to meet specified load ratings

TANDEM plus BLUMOTION	drawer length	minimum inside cabinet depth	runner length	screw locations	
				A	B
569A7620B	762 (30")	786 (30-15/16")	777 (30-19/32")	261 (10-9/32")	389 (15-5/16")
569A6860B	686 (27")	709 (27-29/32")	700 (27-9/16")	261 (10-9/32")	389 (15-5/16")
569A6100B	610 (24")	634 (24-31/32")	625 (24-19/32")	261 (10-9/32")	389 (15-5/16")
569F5330B	533 (21")	557 (21-15/16")	548 (21-9/16")	261 (10-9/32")	517 (20-11/32")
569F4570B	457 (18")	480 (18-29/32")	471 (18-17/32")	261 (10-9/32")	453 (17-27/32")

Inset drawer

Application

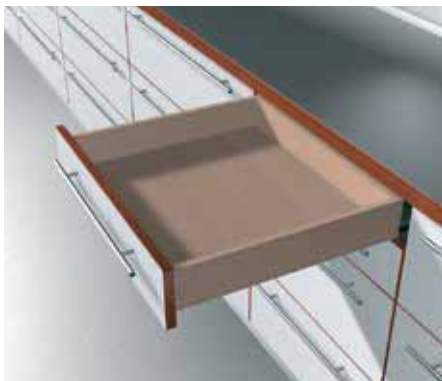

Description

- Uses the same 563 or 569 series runner
- Requires increased setback of the runner
- Frame applications require blocking-out behind the face frame

Basic components

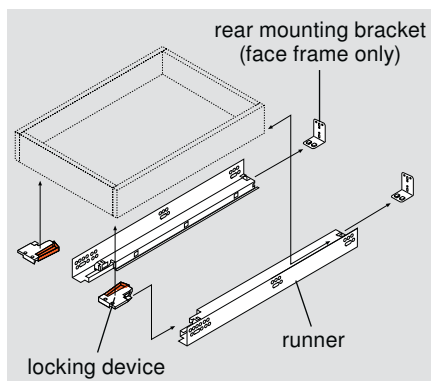

Optional inset spacer for SERVO-DRIVE

For applications where there would not be enough space behind the drawer box to add SERVO-DRIVE due to cabinet construction, plumbing, etc.

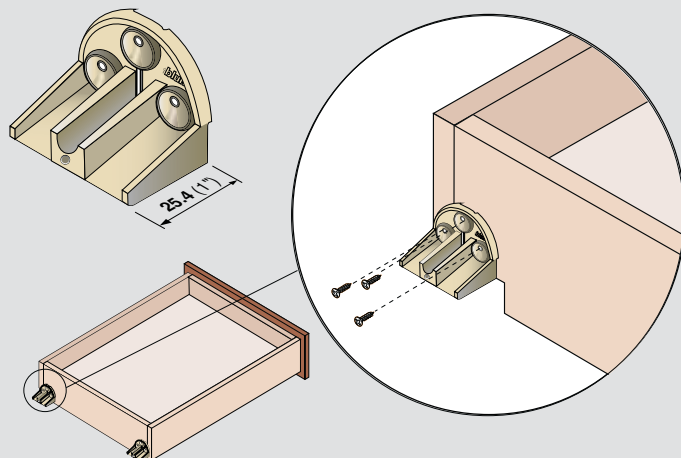

- Two required per drawer
- Drawer box is built **25.4 (1")** shorter in length than TANDEM specifications
- These spacers make up the difference between the drawer box and rear hook and provide additional space for installing SERVO-DRIVE
- SERVO-DRIVE boring locations and minimum inside cabinet depths move towards the cabinet face by **25.4 (1")**

Part no.

Inset spacer	T59.A5P0S
Installation screw	606N or 606P

Specifications

Partial block-out

Side view

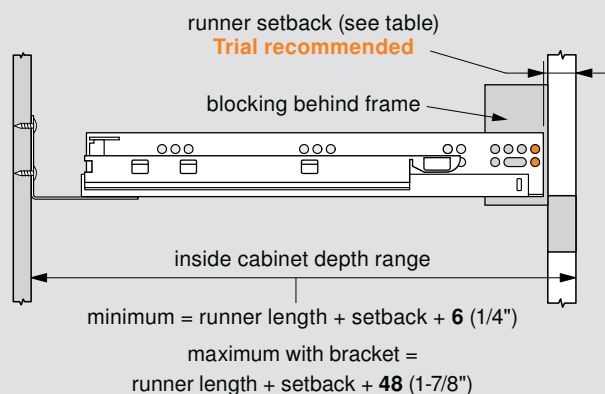

NOTE: Only for 563 H and F series runners

Complete block-out

Side view

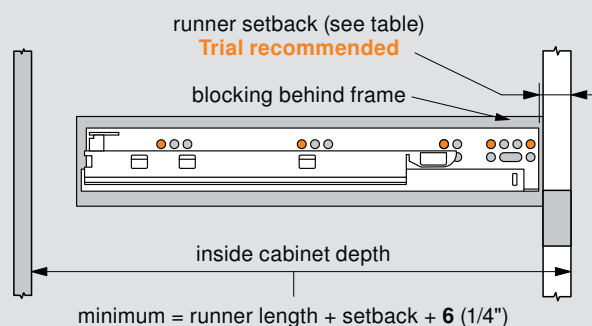

NOTE: Required for 563. and 569 series runners

Locking device specifications



Runner setback when using depth adjustable locking device (T51.1901.PS)



563/569 H./		runner setback			563/569 F/A		runner setback		
sub-front thickness	13 (1/2")	20 (25/32")	23 (29/32")	26 (1-1/32")	sub-front thickness	13 (1/2")	17 (21/32")	20 (25/32")	23 (29/32")
	16 (5/8")	23 (29/32")	26 (1-1/32")	29 (1-5/32")		16 (5/8")	20 (25/32")	23 (29/32")	26 (1-1/32")
	19 (3/4")	26 (1-1/32")	29 (1-5/32")	32 (1-1/4")		19 (3/4")	23 (29/32")	26 (1-1/32")	29 (1-5/32")
		16 (5/8")	19 (3/4")	22 (7/8")			16 (5/8")	19 (3/4")	22 (7/8")
		drawer front thickness					drawer front thickness		

- Setbacks in this table recess the face of the drawer front inside of the cabinet 1 (1/32")
- The depth adjustment can then be used to move the drawer front out to its desired position, 2.5 (3/32") out adjustment only

calculating runner setback

563/569 H./ (sub-front thickness + drawer front thickness minus 9 (11/32") = runner setback)

563/569 F/A (sub-front thickness + drawer front thickness minus 12 (15/32") = runner setback)

NOTE: For mounting hole position, add 7 (9/32") to runner setback

Runner setback when using all other locking devices



563/569 H./		runner setback			563/569 F/A		runner setback		
sub-front thickness	13 (1/2")	17.5 (11/16")	20.5 (13/16")	23.5 (15/16")	sub-front thickness	13 (1/2")	14.5 (9/16")	17.5 (11/16")	20.5 (13/16")
	16 (5/8")	20.5 (13/16")	23.5 (15/16")	26.5 (1-1/32")		16 (5/8")	17.5 (11/16")	20.5 (13/16")	23.5 (15/16")
	19 (3/4")	23.5 (15/16")	26.5 (1-1/32")	29.5 (1-5/32")		19 (3/4")	20.5 (13/16")	23.5 (15/16")	26.5 (1-1/32")
		16 (5/8")	19 (3/4")	22 (7/8")			16 (5/8")	19 (3/4")	22 (7/8")
		drawer front thickness					drawer front thickness		

- Setbacks in this table set the face of the drawer front flush with the face of the cabinet
- If a depth adjustable locking device is needed, please see the locking device and table above

calculating runner setback

563/569 H./ (sub-front thickness + drawer front thickness minus 11.5 (7/16") = runner setback)

563/569 F/A (sub-front thickness + drawer front thickness minus 14.5 (9/16") = runner setback)

NOTE: For mounting hole position, add 7 (9/32") to runner setback

Setback information

Side view

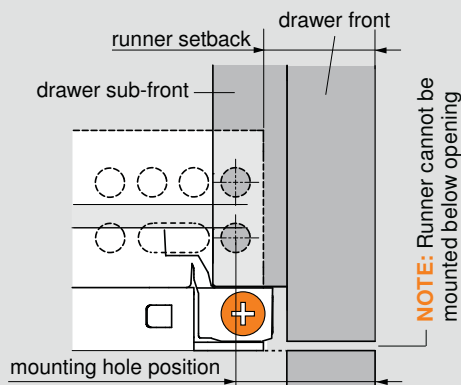

NOTE: For mounting hole position add 7 (9/32") to runner setback

Narrow drawer

Application



Description

- For inside drawer widths of **95** (3-3/4") to **124** (4-7/8")
- Special narrow locking device required
- Maximum dynamic load rating for narrow drawer locking device is 25 lb
- Minimum **16** (5/8") sub-front thickness

Basic components

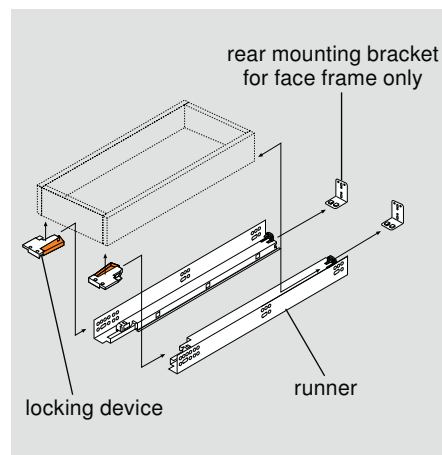

Components

Runner set

One set required per drawer



Narrow drawer applications are possible with any TANDEM plus BLUMOTION runner. See the installation instructions for the runner used.

TANDEM plus BLUMOTION

563. series	page 12
563H series	page 14
563F series	page 16

Narrow drawer locking device



- One right and one left required per drawer
- For use with narrow drawers
- Maximum dynamic load capacity 25 lb
- Self-adjusting drawer length tolerance
- Vertical mount, two-piece nylon
- Minimum inside drawer width **95** (3-3/4")
- Height adjustment **+3** (1/8")
- Minimum sub-front thickness **16** (5/8")
- Designed for **13** (1/2") drawer bottom recess
- For use with 563/569 series runners only

Part no.

Right locking device **T51.0801.20 R**

Left locking device **T51.0801.20 L**

Installation screw **606N or 606P**

Installation

page 25

Rear mounting bracket for frame cabinets



For use when installing TANDEM runners in face frame cabinets. Not necessary for panel cabinet installation.

- Two required per drawer
- Depth and lateral self-alignment
- Zinc-coated steel
- For 9" TANDEM rear attachment options, see page 35

Part no.

Non-handed bracket **295.3750.01**

Installation screw **606N or 606P**

Using TANDEM

page 10

Drawer preparation

page 11

Accessories

page 42

Assembly aids

page 44

Drawer and cabinet specifications



Attach locking devices

- 1 Position locking device in front corner of the drawer
- 2 Pre-bore locking device mounting screw holes with $\varnothing 2.5$ mm piloting bit
- 3 Attach with two 606N or 606P screws
- 4 Repeat on the other side

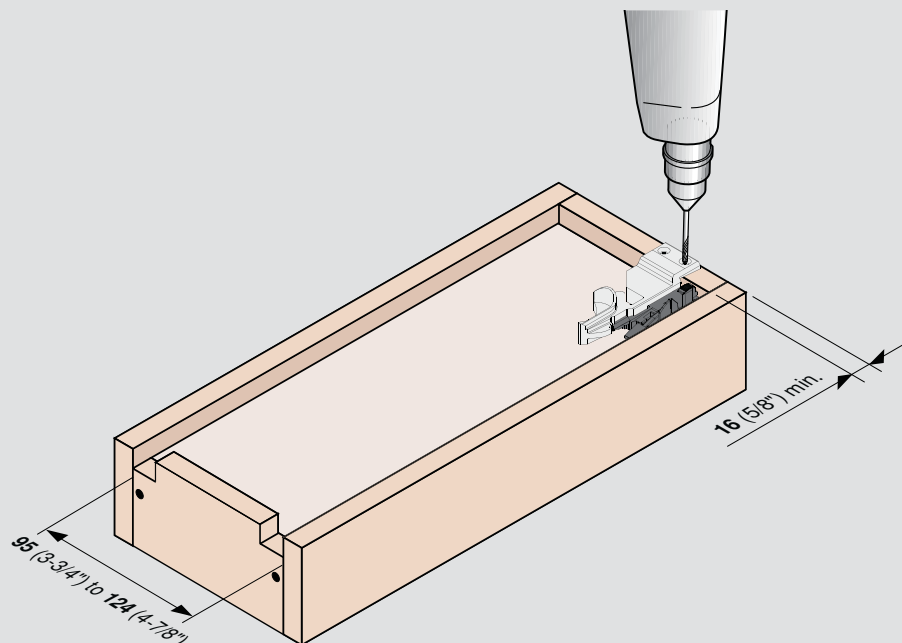

NOTE: A minimum of 16 (5/8") sub-front thickness is required for mounting the narrow drawer locking device

Drawer back preparation

Rear view

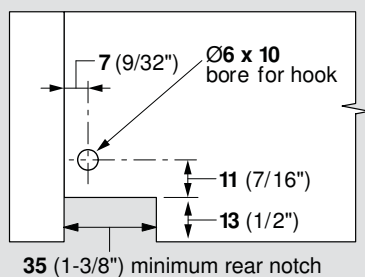

Drawer removal

- 1 Squeeze release levers on locking devices
- 2 Pull drawer straight out and up

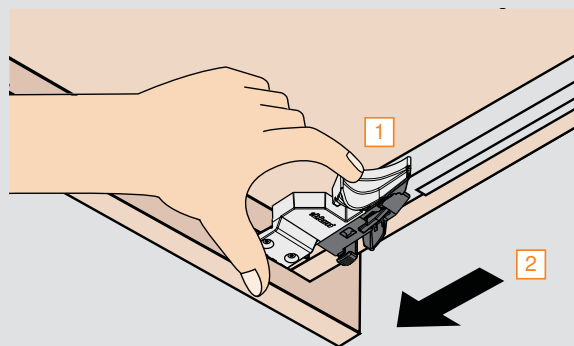

Lateral Stabilizer for 563/569

Application



Description

- Increases lateral stability
- Synchronizes left and right runners to prevent drawer racking
- Ideal for wide applications using TANDEM 563/569 H./, and F/A series
- Does not increase load capacity

Specifications

- Panel and blocked-out face frame applications **229** (9") to **686** (27") length drawers
- Face frame applications with rear attachment **305** (12") to **533** (21") length drawers
- Recommended for opening widths **610** (24") and wider



Lateral stabilizer set



Set includes:

- 1 Pinion housing (qty 2)
- 2 Gear rack with locating tabs (qty 2)
- 3 Linkage rod, length **1054** (41-1/2")
- 4 Pinion adapter (qty 2)
- 5 Locking clip (qty 2)
- Installation instructions

Part no.

Lateral stabilizer set

ZST.686TU01

Space requirements

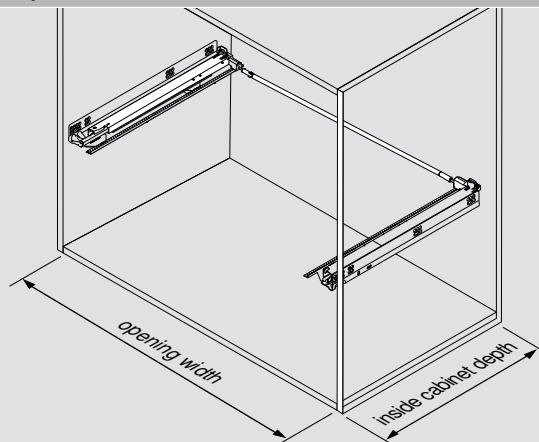

- Maximum opening width **1352** (53-7/32")
- Minimum inside cabinet depth = setback + runner length + **18** (23/32")

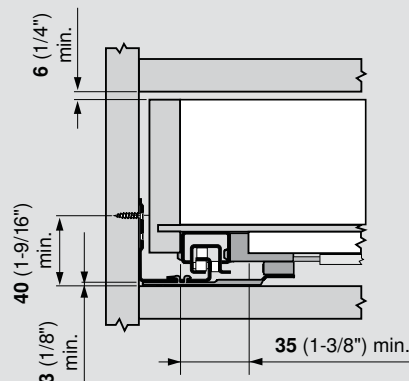

NOTE: TANDEM runners will sit **3** (1/8") higher when using the lateral stabilizer in bottom mount applications and may have to be raised for some bottom mount drawer applications using SERVO-DRIVE

Installation instructions

Step 1 – Attach left and right pinion housings

- 1 Insert locating pins into TANDEM runner
- 2 Press orange locking clips to lock into place

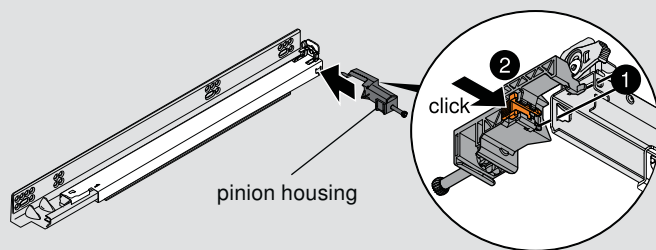

Step 2 – Slide gear racks into pinion housings

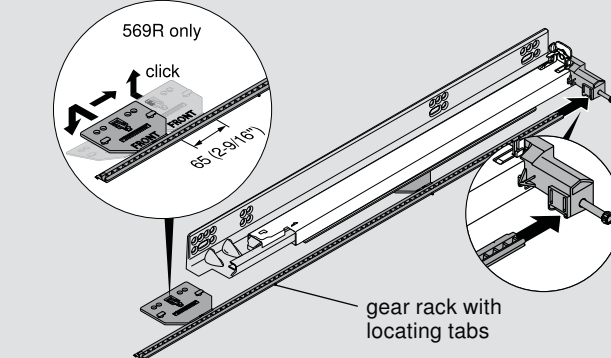

Step 3 – Install gear racks

- 1 Insert locating tabs into cut-outs on bottom of runners
- 2 Slide backward to lock into place

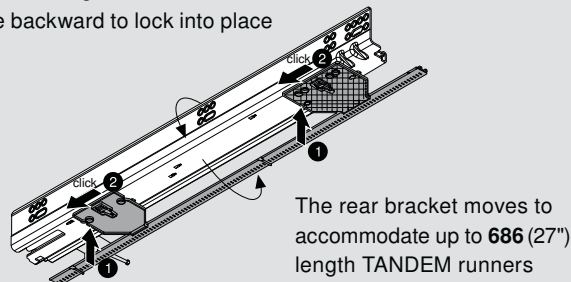

Step 4 – Cut gear racks to length

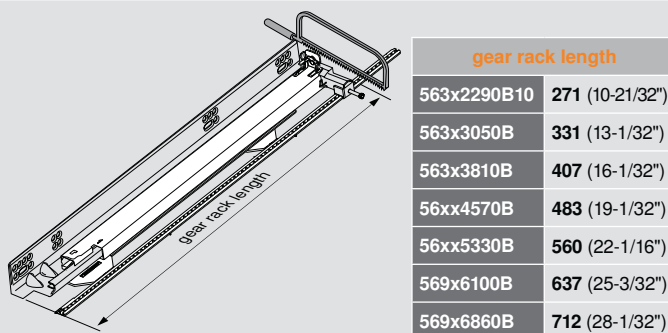

Step 5 – Cut linkage rod to length

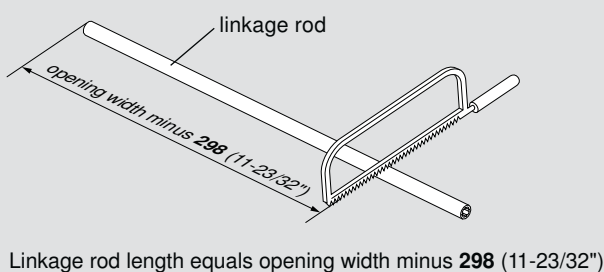

Step 6 – Press pinion adapters into linkage rod

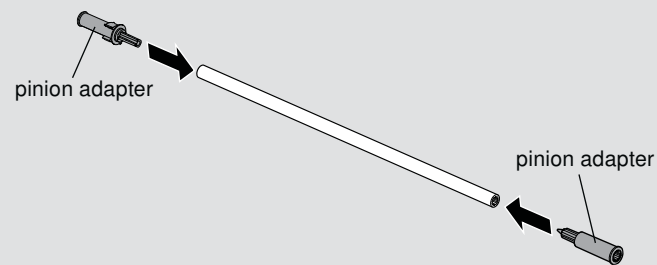

Step 7 – Install linkage rod assembly

- 1 Close drawer runners
- 2 Slide linkage rod assembly left onto left pinion
- 3 Slide right pinion adapter onto right pinion

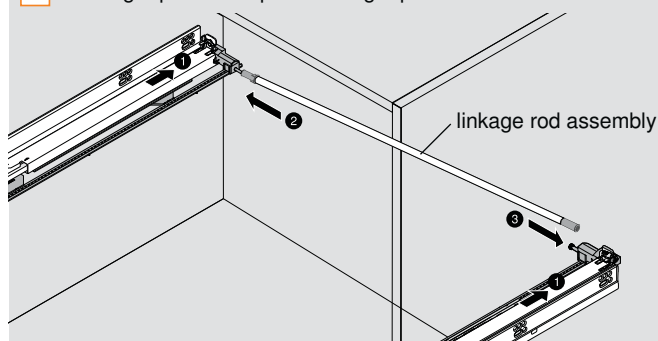

Step 8 – Install locking clips

Install locking clips on both adapters

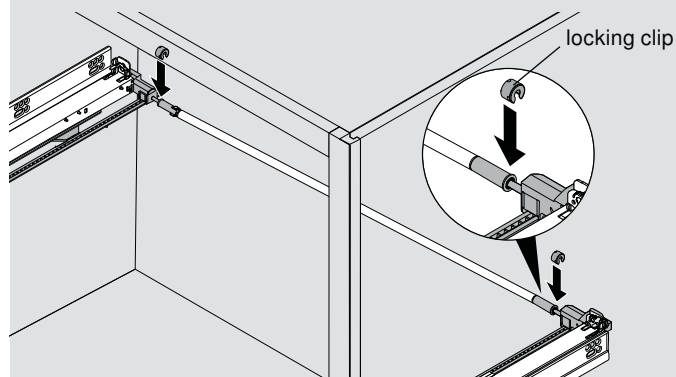

Roll-out shelf

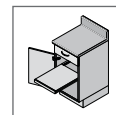

Application



Description

- Possible with any TANDEM runner
- **100 lb static load capacity**

Basic components

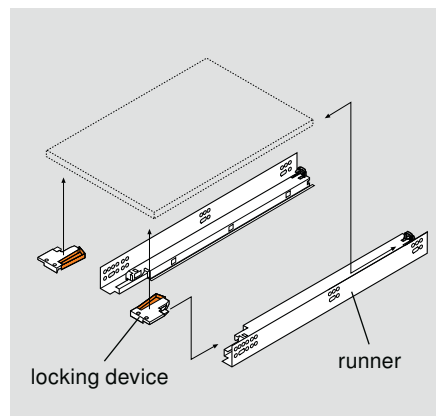

Components

Shelf size and position in opening

Front view

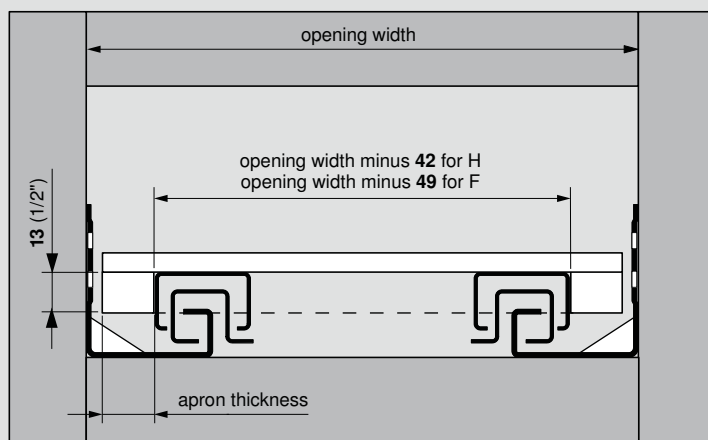

Maximum apron thickness **16 (5/8")** for H
Maximum apron thickness **19 (3/4")** for F

Rear mounting block

Attach rear mounting block to the back of the shelf instead of notching and boring

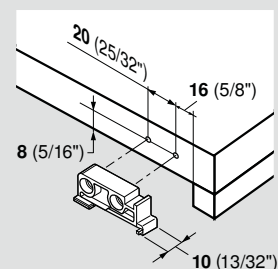

- Eliminates the need to edge bore holes for hooks on roll-outs

NOTE: Shelf length = specified runner length minus **10 (13/32")**

	Part no.
Rear mounting block	T51.7000.01
Installation screw	6064N

Side adjustable locking device



- One right and one left required per drawer
- With side-to-side adjustment
- Self-adjusting drawer length tolerance
- Minimum inside drawer width **170 (6-11/16")**
- Height adjustment **+3 (1/8")**
- Side adjustment **±1.5 (1/16")**
- For use with 563/569 series runners only
- For other options see page 32

Part no.

Right locking device **T51.1901 R**

Installation Left locking device **T51.1901 L**

page 11 Installation screw **606N or 606P**

Shelf assembly

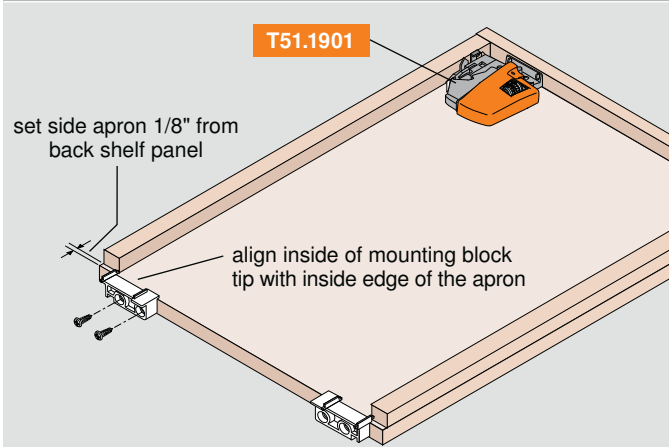

Bottom mount drawer

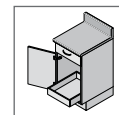

Application



Description

- Use 563H, 563, or 563F series in 15", 18" and 21" lengths
- Face frame or panel cabinets
- Application is possible with any TANDEM 563/569 locking device
- 13 (1/2") to 19 (3/4") drawer thickness
- 100 lb static load capacity**
- Heavy duty bottom mount application possible with 568R runners on page 38

Basic components

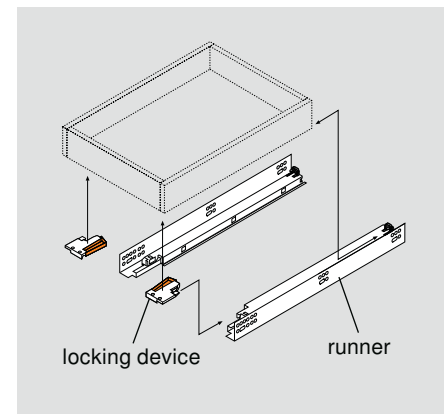

Components

Runner set

One set required per drawer



maximum drawer material thickness	for overall cabinet depth	drawer length	TANDEM plus BLUMOTION
16 (5/8")	610 (24")	533 (21")	563.5330B
	533 (21")	457 (18")	563.4570B
	610 (24")	533 (21")	563H5330B
	533 (21")	457 (18")	563H4570B
	457 (18")	381 (15")	563H3810B
19 (3/4")	610 (24")	533 (21")	563F5330B
	533 (21")	457 (18")	563F4570B
	457 (18")	381 (15")	563F3810B
Wood screw for installation			606N or 606P
System screw for installation			662.1150.HG

Runner mounting specifications

Top view

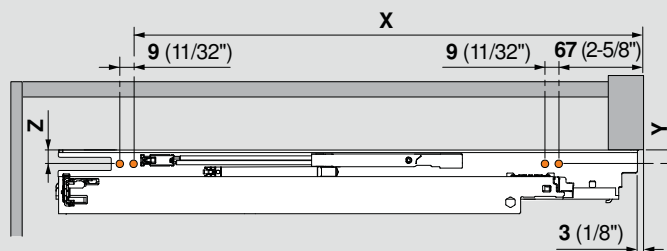

TANDEM plus BLUMOTION	drawer length	minimum inside cabinet depth	X	Y	Z
563.5330B	533 (21")	557 (21-15/16")	358 (14-3/32")	12 (15/32")	19 (3/4")
563.4570B	457 (18")	480 (18-29/32")	358 (14-3/32")	12 (15/32")	19 (3/4")
563H5330B	533 (21")	557 (21-15/16")	448 (17-5/8")	12 (15/32")	19 (3/4")
563H4570B	457 (18")	480 (18-29/32")	378 (14-7/8")	12 (15/32")	19 (3/4")
563H3810B	381 (15")	404 (15-29/32")	319 (12-9/16")	12 (15/32")	19 (3/4")
563F5330B	533 (21")	557 (21-15/16")	448 (17-5/8")	15.5 (5/8")	22.5 (7/8")
563F4570B	457 (18")	480 (18-29/32")	378 (14-7/8")	15.5 (5/8")	22.5 (7/8")
563F3810B	381 (15")	404 (15-29/32")	319 (12-9/16")	15.5 (5/8")	22.5 (7/8")

SPACE CORNER

Application



Description

- Use longer length heavy duty TANDEM plus BLUMOTION runners
- Requires special cabinet and drawer construction (see note below)
- For **16** (5/8") maximum drawer side material use 569. series
- For **19** (3/4") maximum drawer side material use 569A series
- **150 lb static load capacity**

Basic components

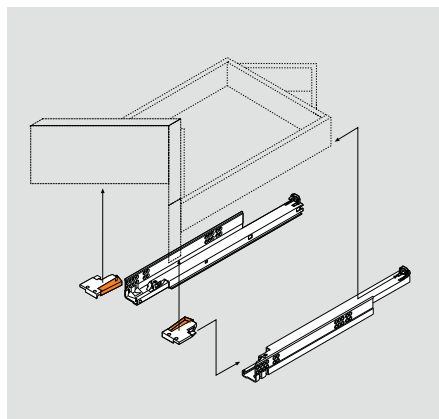

Components

Runner set

One set required per drawer



Sample SPACE CORNER drawer and cabinet plans are available for download at blum.com

corner cabinet size	maximum 5/8" drawer side thickness	maximum 3/4" drawer side thickness
36", 39" or 42"	569.6860B	569A6860B
Wood screw for installation	606N or 606P	
System screw for installation	662.1150.HG	

NOTE: SPACE CORNER requires special cabinet and drawer construction. See suggestions on cabinet construction at blum.com.

Side adjustable locking device



- One right and one left required per drawer
- With side-to-side adjustment
- Captive right and self-aligning left device
- Self-adjusting drawer length tolerance
- Steel base with synthetic, spring-loaded release levers
- Minimum inside drawer width **170** (6-11/16")
- Height adjustment **+3** (1/8")
- Side adjustment **±1.5** (1/16")
- For use with 563/569 series runners only
- For other options see page 32

Part no.

Right locking device **T51.1901 R**

Installation Left locking device **T51.1901 L**

page 11 Installation screw **606N or 606P**

Measuring corner cabinet size

Top view

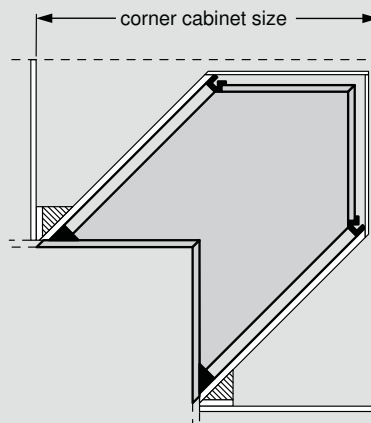

Using TANDEM

page 10

Drawer preparation

page 11

Accessories

page 42

Assembly aids

page 44

Drawer construction

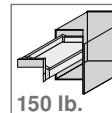

For a 39" SPACE CORNER using 5/8" material and 569.6860B

Top view

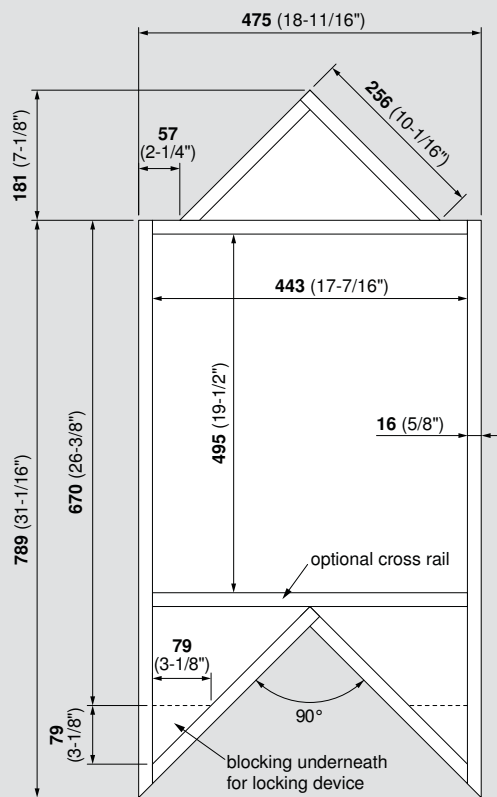

For a 39" SPACE CORNER using 3/4" material and 569A6860B

Top view

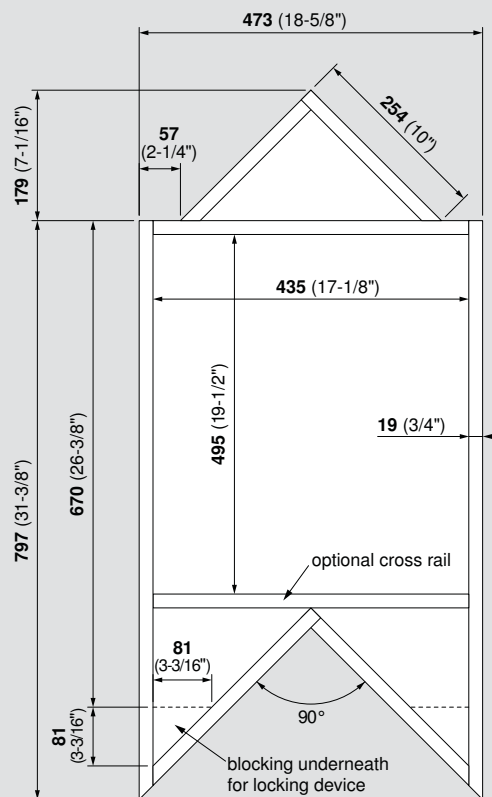

Mounting locations

Side view

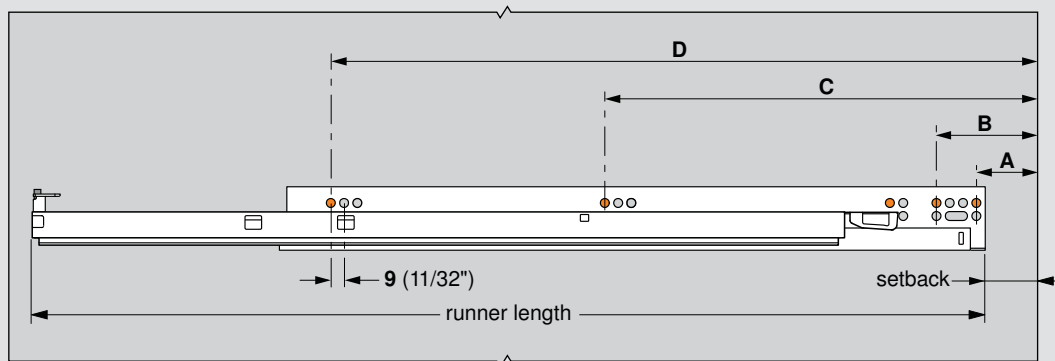

NOTE: Detailed drawings for cabinet construction are available at blum.com

TANDEM plus BLUMOTION	drawer material	setback	A	B	C	D
569.6860B	16 (5/8")	107 (4-7/32")	114 (4-1/2")	141 (5-9/16")	365 (14-3/8")	493 (19-13/32")
569A6860B	19 (3/4")	116 (4-9/16")	123 (4-27/32")	150 (5-29/32")	374 (14-23/32")	502 (19-3/4")

Locking devices for 563/569 series

With side adjustment

Standard

One right and one left required per drawer



- With side-to-side adjustment
- Captive right device and self-aligning left device
- Self-adjusting drawer length tolerance
- Steel base with synthetic, spring-loaded release levers
- Minimum inside drawer width **170** (6-11/16")
- Height adjustment **+3** (1/8")
- Side adjustment **±1.5** (1/16")

Part no.

Right locking device	T51.1901 R
Left locking device	T51.1901 L
Installation screw	606N or 606P

Vertical mount

One right and one left required per drawer



- Vertical mount locking device used to minimize sub-front splitting
- Captive right device and self-aligning left device
- Self-adjusting drawer length tolerance
- Steel base with synthetic, spring-loaded release levers
- Minimum inside drawer width **170** (6-11/16")
- Height adjustment **+3** (1/8")
- Side adjustment **±1.5** (1/16")
- Minimum sub-front thickness **16** (5/8")
- Designed for **13** (1/2") drawer bottom recess

Part no.

Right locking device	T51.1901.20 R
Left locking device	T51.1901.20 L
Installation screw	606N or 606P

Depth adjustable

One right and one left required per drawer



- Captive right device and self-aligning left device
- Self-adjusting drawer length tolerance
- Steel base with synthetic, spring-loaded release levers
- Minimum inside drawer width **170** (6-11/16")
- Height adjustment **+3** (1/8")
- Side adjustment **±1.5** (1/16")
- Depth adjustment **+2.5** (3/32"), preset at **0**
- Minimum sub-front thickness **13** (1/2")
- Designed for **13** (1/2") drawer bottom recess
- Integrated **3** (1/8") distance bumper for inset or overlay SERVO-DRIVE applications

Part no.

Right locking device	T51.1901.PS R
Left locking device	T51.1901.PS L
Installation screw	606N or 606P

Without side adjustment

Standard

One right and one left required per drawer



- For use with standard applications
- Captive right device and self-aligning left device
- Self-adjusting drawer length tolerance
- Zinc die-cast with synthetic, spring-loaded release levers
- Minimum inside drawer width **124** (4-7/8")
- Height adjustment **+3** (1/8")

Part no.

Right locking device	T51.1801 R
Left locking device	T51.1801 L
Installation screw	606N or 606P

Vertical mount

One right and one left required per drawer



- Vertical mount locking device used to minimize sub-front splitting
- Captive right device and self-aligning left device
- Self-adjusting drawer length tolerance
- Zinc die-cast with synthetic, spring-loaded release levers
- Minimum inside drawer width **124** (4-7/8")
- Height adjustment **+3** (1/8")
- Minimum sub-front thickness **16** (5/8")
- Designed for **13** (1/2") drawer bottom recess

Part no.

Right locking device	T51.1801.20 R
Left locking device	T51.1801.20 L
Installation screw	606N or 606P

Narrow drawer

One right and one left required per drawer



- For use with narrow drawers
- Maximum dynamic load capacity 25 lb
- Captive right device and self-aligning left device
- Self-adjusting drawer length tolerance
- Vertical mount, two-piece nylon
- Minimum inside drawer width **95** (3-3/4")
- Height adjustment **+3** (1/8")
- Minimum sub-front thickness **16** (5/8")
- Designed for **13** (1/2") drawer bottom recess

Part no.

Right locking device	T51.0801.20 R
Left locking device	T51.0801.20 L
Installation screw	606N or 606P

Rear attachment options

Screw-on bracket

Two required per drawer



- For TANDEM 563 H/F series runners only
- Lateral self-alignment **3** (1/8")
- Non-handed, one-piece stamped steel design, zinc-coated
- Use at least three #6 wood screws
- Not for use with 9" runners

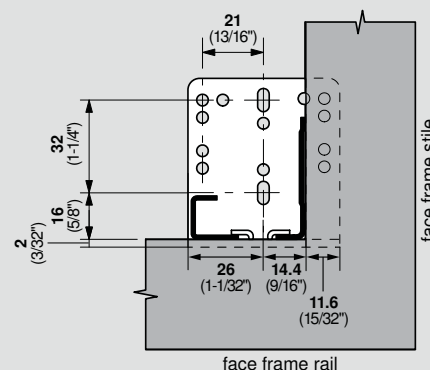

Part no.

Screw-on bracket

295.3750.01

NOTE: Illustration is for 562/563 series

Installation screw

606N or 606P

Narrow screw-on bracket

Two required per drawer



- For TANDEM 563 H/F series runners only
- For applications with side recess space limitations (end panel)
- Maximum dynamic load capacity 45 lb
- Lateral self-alignment **3** (1/8")
- Non-handed, one-piece stamped steel design, zinc-coated
- Use at least three #6 wood screws
- Maximum inside cabinet depth is **15** (19/32") less than 295.3750.01 allows
- Not for use with 9" runners

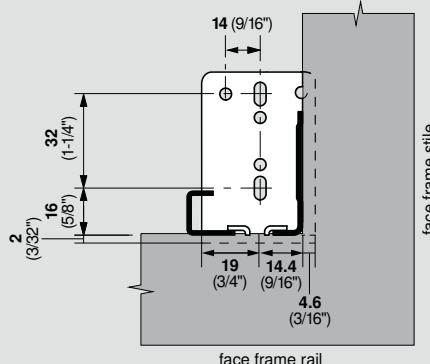

Part no.

Screw-on bracket

295.3550.01

NOTE: Illustration is for 562/563 series

Installation screw

606N or 606P

Plug-in socket

Two required per drawer



- For TANDEM 563 H/F series runners only
- Lateral self-alignment feature
- Non-handed, two-piece design
- Synthetic, natural color
- Non-detachable **8** (5/16") dowels, **9.5** (3/8") long
- 6** (1/4") minimum back panel thickness
- Not for use with 9" runners

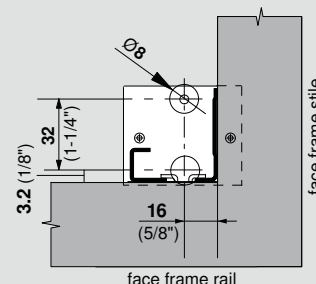

Part no.

Plug-in socket

295.6410

Installation screw

606N or 606P

Screw-on socket

Two required per drawer



- For TANDEM 563 H/F series runners only
- Lateral self-alignment
- Non-handed, two-piece design
- Synthetic, natural color
- Use two #6 flat head wood screws
- Not for use with 9" runners

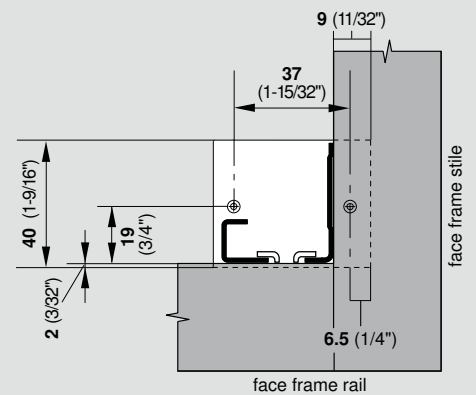

Part no.

Screw-on socket

295.6400

Installation screw

606N or 606P

Screw-on socket for 9" TANDEM plus BLUMOTION runners

Two required per drawer



- For TANDEM 563 H/F series 9" runners only
- For use only when installing 9" runners in face frame cabinets
- For inside cabinet depths **266** (10-15/32") to **282** (11-3/32")
- Minimum opening width **156** (6-5/32")
- Lateral self-alignment
- Non-handed, two-piece design
- Synthetic, natural color
- Use at least three #6 wood screws

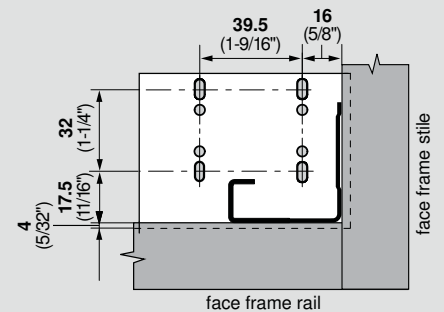

Part no.

Screw-on socket

295.3700.21

Installation screw

606N or 606P

Screw-on socket for 9" TANDEM plus BLUMOTION runners

Two required per drawer



- For TANDEM 563 H/F series 9" runners only
- For use only when installing 9" runners in face frame cabinets
- For inside cabinet depths **283** (11-5/32") to **299** (11-25/32")
- Minimum opening width **156** (6-5/32")
- Lateral self-alignment
- Non-handed, two-piece design
- Synthetic, natural color
- Use at least three #6 wood screws

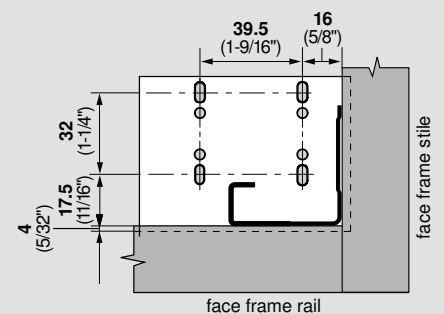

Part no.

Screw-on socket

295.3700.22

Installation screw

606N or 606P

Waste/recycle drawer with SERVO-DRIVE

Application



Description

- Pre-assembled bottom mount set
- TANDEM plus BLUMOTION heavy duty full extension concealed drawer runners
- For 12", 15" and 18" minimum opening widths
- For 16 (5/8") max. drawer side thickness
- For face frame and panel applications
- Tool-free height and tilt adjustment
- Maximum 6 (1/4") cabinet bottom recess
- **125 lb static load capacity**
- SERVO-DRIVE touch-to-open feature

Basic components

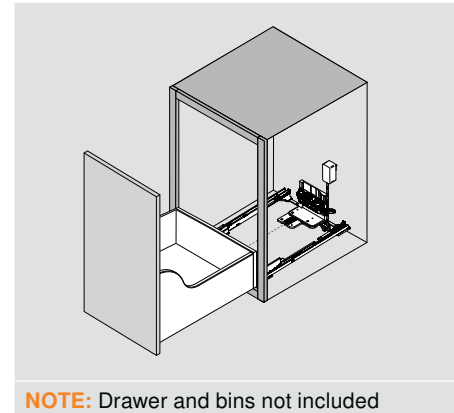

NOTE: Drawer and bins not included

Components

TANDEM waste/recycle set

One set required per drawer

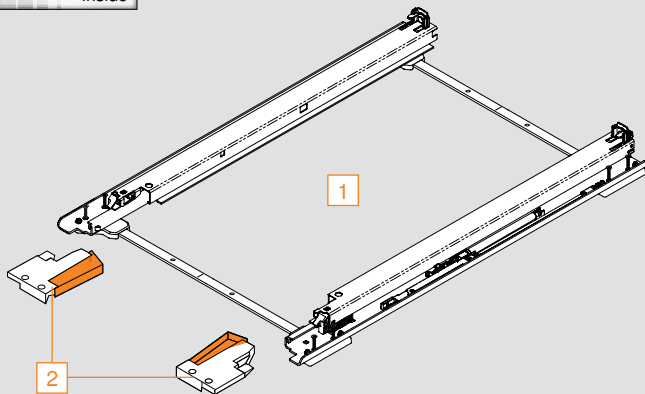
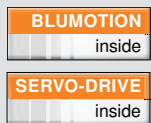

Set includes:

- 1 TANDEM plus BLUMOTION heavy duty runner set with pre-mounted #6 x 1" wood screws for installation (qty 8)
- 2 Standard locking device (qty 2) with #6 x 1/2" truss head wood screws for installation (qty 4)
- Installation template and instructions

minimum opening width	drawer length	TANDEM waste/recycle set
305 (12")	533 (21")	568R5337BB
381 (15")	533 (21")	568R5337BD
457 (18")	533 (21")	568R5337BF

SERVO-DRIVE waste/recycle set

One set required per drawer

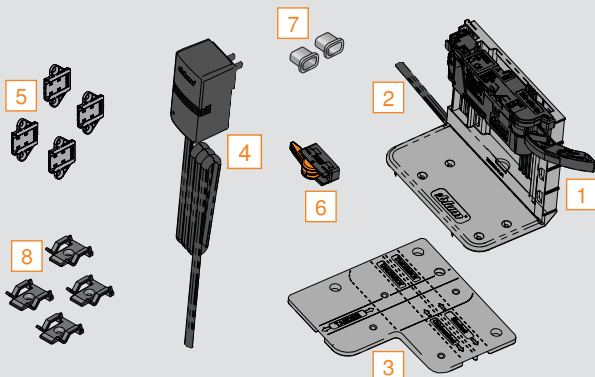

Set includes:

- 1 Drive unit (pre-attached)
- 2 Double bottom bracket with #6 x 1" wood screws (qty 2)
- 3 Adapter plate
- 4 110V plug-in power supply with six feet of universal cable
- 5 Screw-on distance bumpers (qty 4) with #6 x 5/8" wood screws for installation (qty 8)
- 6 INSERTA cable connector
- 7 Cable end protectors (qty 2)
- 8 Cable clips (qty 4)
- Installation template, instructions and user manual

Part no.

SERVO-DRIVE waste/recycle set

Z10NA20UGUS

Drawer and cabinet specifications

Maximum drawer thickness	16 (5/8")
Lengths available	21"
Static load capacity	125 lb

Drawer box specifications

Front view

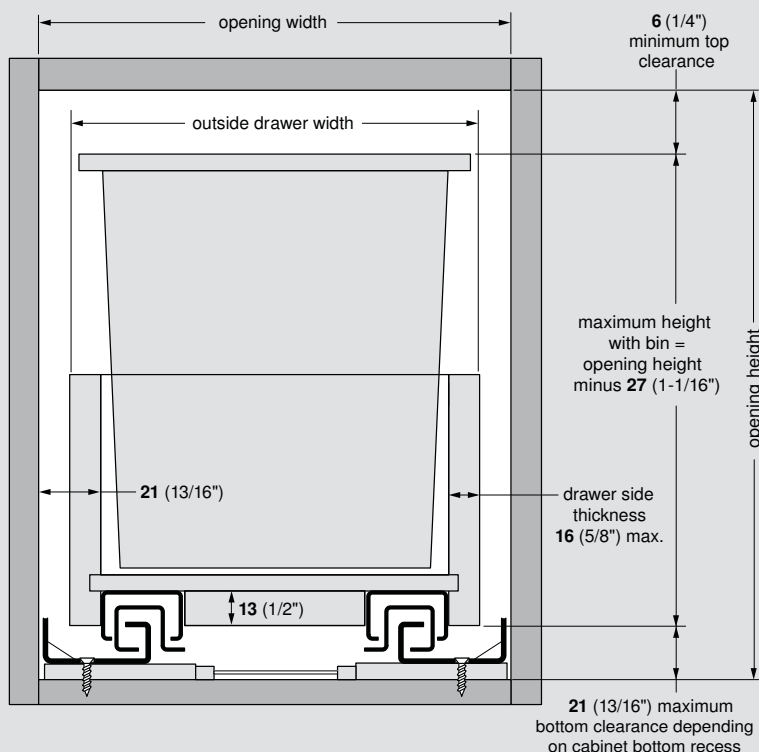

Important

Bin width and height must be considered when designing your cabinet and drawer (see the diagram on the left)

Minimum inside cabinet depth

With SERVO-DRIVE	577 (22-23/32")
Without SERVO-DRIVE	556 (21-7/8")

Drawer back preparation

Rear view

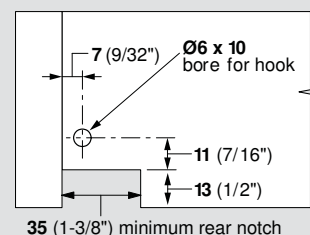

waste/recycle set	opening width	Z	for drawer side thickness				
			16 (5/8")	15 (19/32")	14 (9/16")	13 (1/2")	12 (15/32")
568R5337BB	305 (12")	141.5 (5-9/16")	295 (11-5/8")	293 (11-17/32")	291 (11-15/32")	289 (11-3/8")	287 (11-5/16")
568R5337BD	381 (15")	179.5 (7-1/16")	371 (14-19/32")	369 (14-17/32")	367 (14-7/16")	365 (14-3/8")	363 (14-9/32")
568R5337BF	457 (18")	217.5 (8-9/16")	447 (17-19/32")	445 (17-17/32")	443 (17-7/16")	441 (17-3/8")	439 (17-9/32")
			outside drawer width				

NOTE: Drawer length is 533 (21") for all sets

Set mounting specifications

Top view

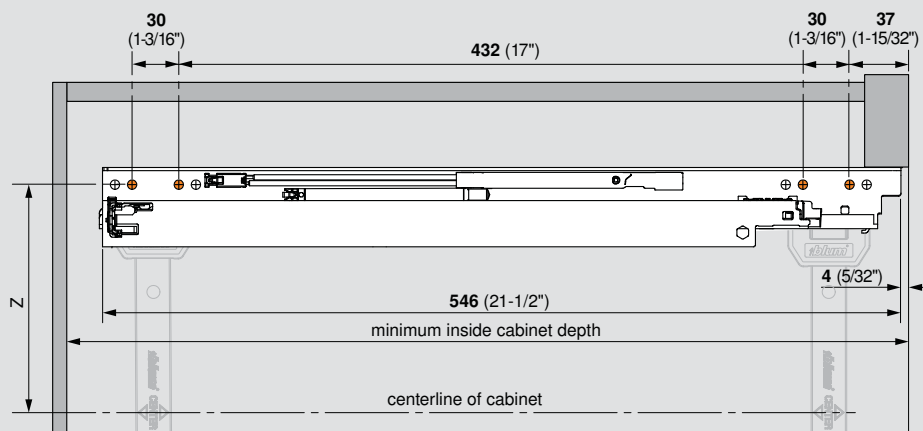

NOTE: Orange dots indicate pre-mounted screw locations. All four are required to meet specified load capacities.

Bottom mount drawer – heavy duty

Application



Description

- Full extension bottom mount concealed drawer runners with BLUMOTION
- For **16 (5/8")** max. drawer side thickness
- For face frame and panel applications
- Tool-free height and tilt adjustment
- Concealed roller carriages with permanently lubricated synthetic rollers create a smooth running action
- Locking devices enable easy drawer insertion and removal
- 125 lb static load capacity**

Basic components

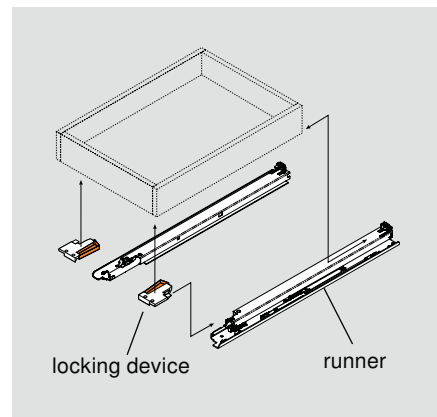

Applications



Bottom mount drawer



Interior roll-out



Roll-out shelf

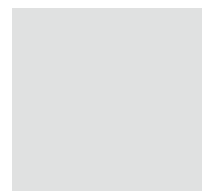
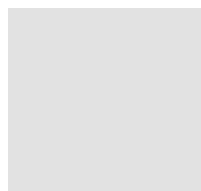
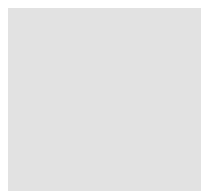

Components

TANDEM plus BLUMOTION bottom mount runner set

One set required per drawer

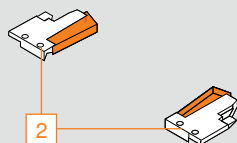
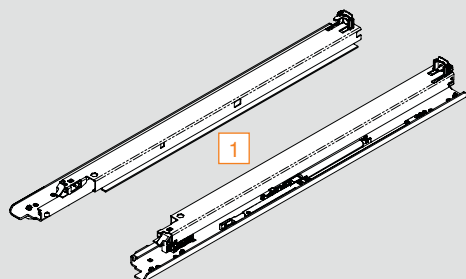

Set includes:

- TANDEM plus BLUMOTION heavy duty runner set with #6 x 5/8" wood screws for installation (qty 10)
 - Standard locking device (qty 2) with #6 x 1/2" truss head wood screws for installation (qty 4)
- Instructions

Interior roll-outs and roll-out shelf applications must be mounted to the bottom of the cabinet or to a fixed shelf/pane

overall cabinet depth	drawer length	TANDEM plus BLUMOTION set
610 (24")	533 (21")	568R5330B
NOTE: These runners are for 16 (5/8") maximum drawer side thickness		
Wood screw for installation		606W

NOTE: Rear brackets and sockets cannot be used. Cabinet bottom must be flush with top surface of bottom rail unless bottom mount spacers are used.

Bottom mount spacer



Used to install bottom mount 568R runners in cabinets with a bottom recess of up to **6 (1/4")**

Part no.

Bottom mount spacer

T59.T570

Drawer and cabinet specifications

Maximum drawer thickness	16 (5/8")
Lengths available	21"
Static load capacity	125 lb

Drawer box specifications

Front view

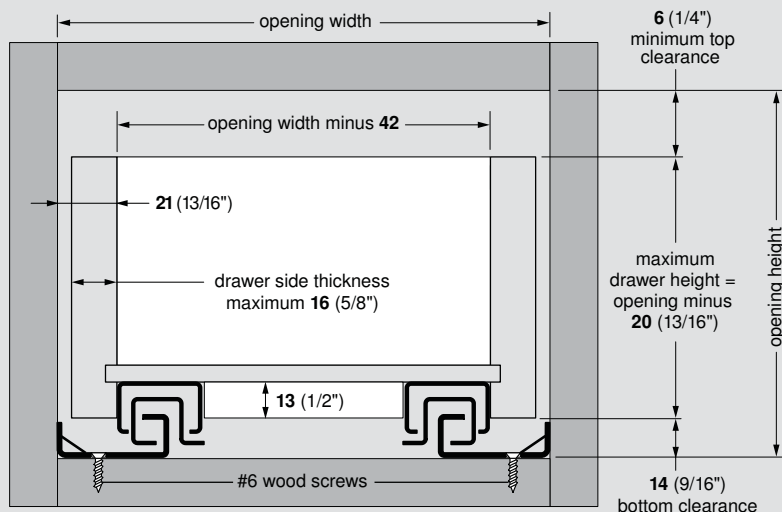

NOTE: Material thickness may vary. Inside drawer width **must** equal opening width minus 42 for TANDEM to align and function properly.

calculating outside drawer width

For drawer side thickness	16 (5/8")	15 (19/32")	14 (9/16")	13 (1/2")	12 (15/32")
Deduct from inside cabinet width	10 (13/32")	12 (15/32")	14 (9/16")	16 (5/8")	18 (23/32")

Example: For 21" inside cabinet width and a 5/8" thick drawer, 21" minus 3/8" = 20-5/8" drawer width

Drawer back preparation

Rear view

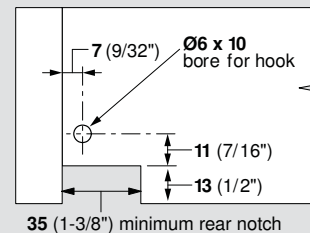

Runner comparison

Side view

568R – No vertical profile



568H – Vertical profile



Profile mounting specifications

Top view

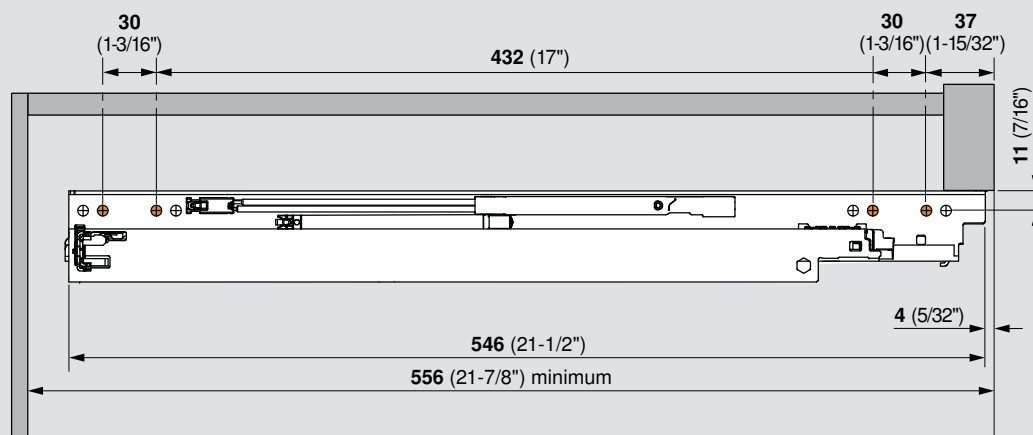

NOTE: Orange dots indicate screw locations required to meet specified load capacities (minimum 4 screws)

TIP-ON for TANDEM plus

Overlay application

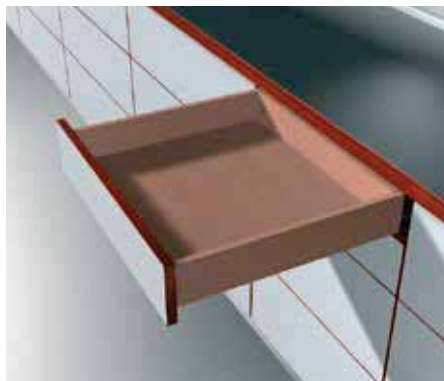

Description

- Designed for drawers without pulls
- Opens the drawer with just a touch of the drawer front
- Tool-free attachment of the mechanism and trigger
- Optimal dynamic load capacity 45 lb
- 100 lb static load capacity**
- Only works with TANDEM plus 562 H/F series runners without BLUMOTION**

Basic components

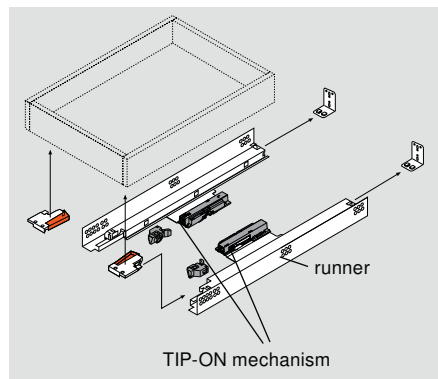

Components

TIP-ON for TANDEM plus set

One set required per drawer

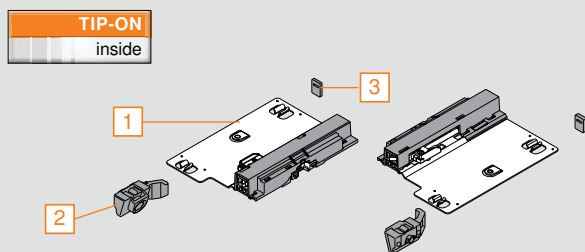

Set includes:

- 1 TIP-ON mechanisms (qty 2)
- 2 Adjustable triggers (qty 2)
- 3 Rear hook spacers (qty 2)

Part no.

TIP-ON for TANDEM plus set

T55.7150S

Runner set

One set required per drawer



for overall cabinet depth	drawer length	TANDEM plus	
		5/8" maximum drawer thickness	3/4" maximum drawer thickness
610 (24")	533 (21")	562H5330C	562F5330C
533 (21")	457 (18")	562H4570C	562F4570C
457 (18")	381 (15")	562H3810C	562F3810C
381 (15")	305 (12")	562H3050C	562F3050C
Wood screw for installation		707N	707N
System screw for installation		661.1300.HG	661.1300.HG

Standard locking device



- One right and one left required per drawer
- Minimum inside drawer width **121** (4-3/4")
- Height adjustable **+3** (1/8")
- For 562/568 series only

Part no.

Right locking device	T51.1700.04 R
Left locking device	T51.1700.04 L
Installation screw	612TH

Rear mounting bracket for frame cabinets



For use when installing TANDEM runners in face frame cabinets. Not necessary for panel cabinet installation.

- Two required per drawer
- Depth and lateral self-alignment
- Zinc-coated steel

Part no.

Non-handed bracket	295.3750.01
Installation screw	612TH

Specifications

Maximum drawer thickness	19 (3/4")
Lengths available	12" - 21"
Static load capacity	100 lb

TANDEM 562H dimensions

Front view

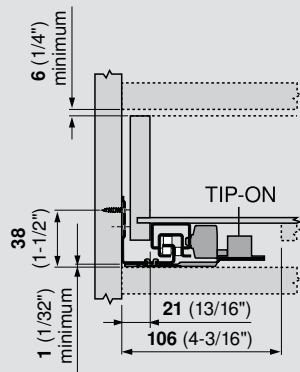

TANDEM 562F dimensions

Front view

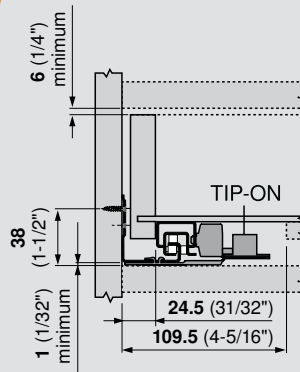

Drawer back preparation

Rear view

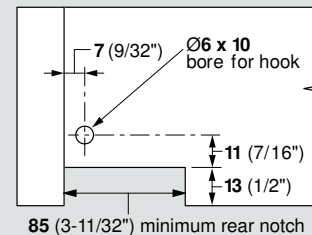

NOTE: Minimum cabinet opening width for TIP-ON is 229 (9")

TIP-ON for TANDEM plus synchronization set (optional)

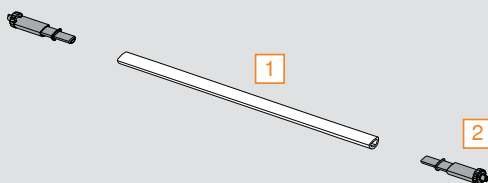

- Recommended for cabinet widths from 610 (24") to 1220 (48") wide (panel and face frame)
- Synchronizes left and right TIP-ON mechanisms to improve function on wide drawers

Set includes:

- 1 Linkage rod, length 908 (35-3/4")
- 2 Pinion gears (qty 2)
- Instruction sheet

Part no.

TIP-ON for TANDEM plus synchronization set

T55.908WR

Assembly and adjustment

Step one – Attachment of mechanism

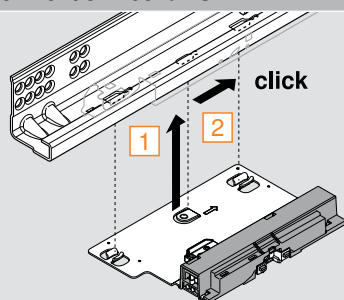

Step two – Attachment of trigger

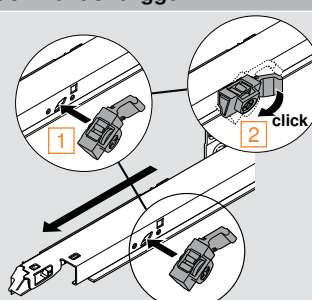

Step three – Attachment of rear hook spacer

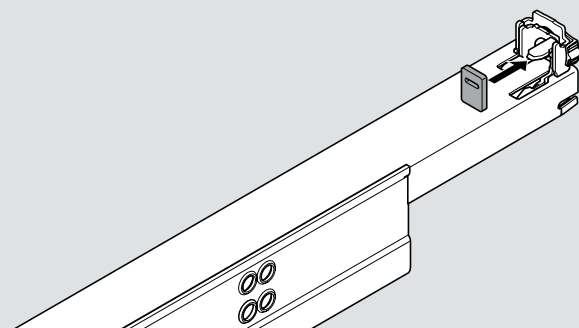

Step four – Front gap adjustment

Trigger allows -1 (1/32") in and +2 (1/16") out adjustment of the drawer front

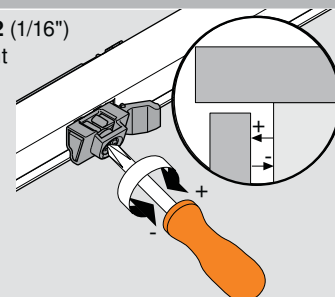

NOTE: Minimum front gap = 2.5 (3/32")

Accessories

Deep thread system screw

Pilot bore $\varnothing 5$ (3/16") hole

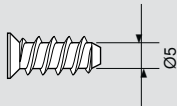

Part no.

#6 x 11.5 mm, #2 POZI	662.1150.HG
#7 x 13 mm, #2 POZI	661.1300.HG
#7 x 14.5 mm, #2 POZI	661.1450.HG

Deep thread wood screw



Part no.

#6 x 5/8", #2 Phillips	606N
#6 x 5/8", #2 POZI	606P
#6 x 1", #2 Phillips	606W
#7 x 5/8", #2 Phillips	707N

Truss head wood screw

Pilot bore $\varnothing 2$ (3/32") hole

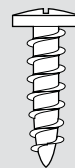

Part no.

#6 x 1/2", #2 Phillips	612TH
------------------------	--------------

Bumpers

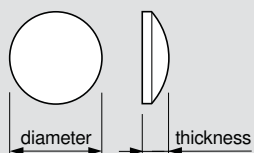

- Cushions door closing
- Clear with a self-adhesive back

Part no.

$\varnothing 7.5$ (9/32") x 2 (3/32")	FX4041
$\varnothing 12$ (15/32") x 3.5 (1/8")	SJ5312

POZI DRIVER and bits



A POZI screwdriver (different from Phillips) is the most crucial tool you can use to assure that full torque is applied to all Blum mounting screws. POZI screws can be identified by the distinctive "tick" marks located in the center of the screw head recess.

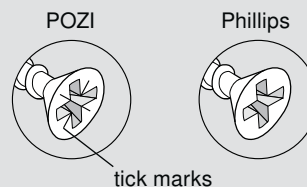

Part no.

#2 POZI DRIVER	POZI DRIVER
1/4" Magnetic bit holder	BIT HOLDER
#2 x 1" POZI bit insert	POZI BIT #2x1
#2 x 2" POZI bit insert	POZI BIT #2x2

Side spacer

For spacing out TANDEM runners from the cabinet side for clearance in interior roll-out applications



Part no.

Side spacer - 1" thick

T59.3570

Side spacer

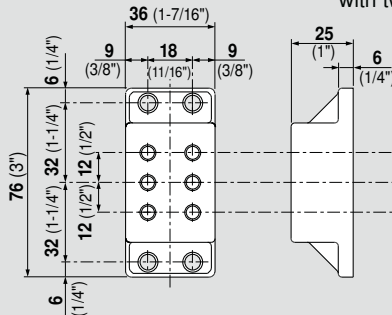

Mount runner to each spacer with two 11.5 mm system screws

662.1150.HG

661.1450.HG

Mount spacer to cabinet with four 14.5 mm system screws

NOTE: Use (2) pieces per runner up to 15" lengths and (3) pieces per runner 18" or longer

Bottom mount spacer

Used to install bottom mount 568R runners in cabinets with a bottom recess of up to 6 (1/4")



Part no.

Bottom mount spacer

T59.T570

Drawer front adjuster

Nylon housing with pre-mounted 8-32 steel nut. For four-sided drawers. Adjusts height and side-to-side by 5 (3/16").

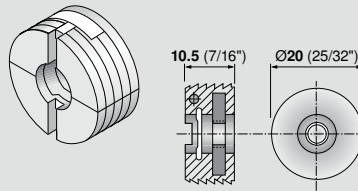

Part no.

Drawer front adjuster

295.1000.21

NOTE: See next page for marking gauge

TANDEM end cap



- To cover the front edge of TANDEM runners when used in an interior roll-out application
- Can be used with TANDEM 562/563 H/F/ runners

Part no.

Right end cap

295.5520

Left end cap

295.5521

TANDEM plus runner cover



- Nylon cover to help protect the runner against dust and debris
- Available in **533** (21") only and can be cut to size
- Designed for 563/569 H/F

Part no.

TANDEM plus cover

295.5510

Attachment

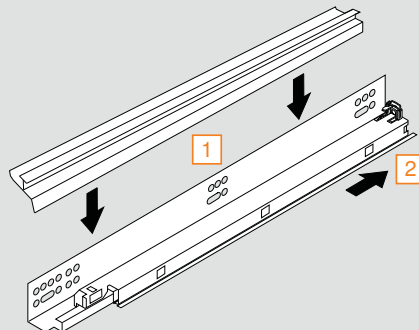

- 1 Lay the cover on top of the runner
- 2 Slide it to the back

Removal

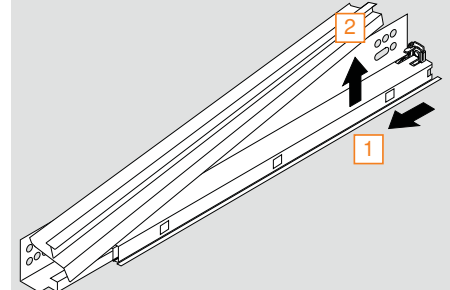

- 1 Slide the cover forward slightly
- 2 Lift the cover off from the rear

Assembly aids

Drawer front adjuster marking gauge

- For marking center holes for press-in drawer front adjusters
- For four-sided wood drawers

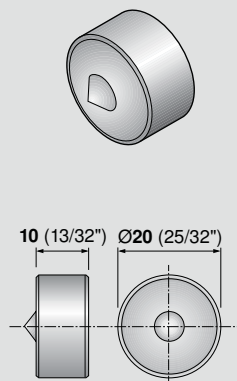

Part no.

Marking gauge

65.2950.10

Using the marking gauge

- Pre-bore for front adjusters and then insert marking gauges into drawer front

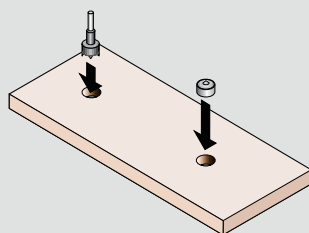

- Align the drawer front to make marks in the drawer box

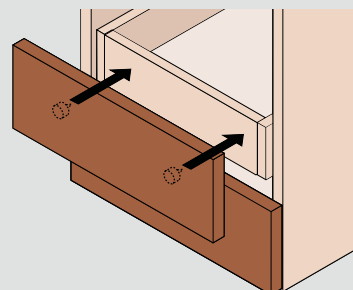

- Mark fixing positions with a light tap onto the drawer front

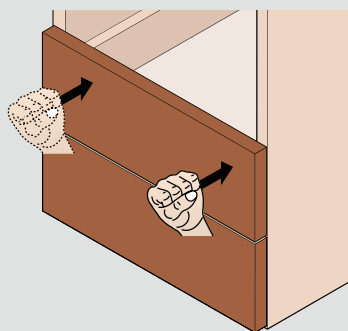

- Bore Ø5 (3/16") holes through the drawer box

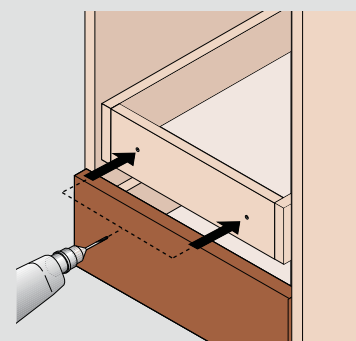

TANDEM template

- Essential tool for drawers using any series TANDEM runners
- To bore the Ø6 mm holes for rear hooks
- Pre-bore Ø2.5 mm hole for TANDEM locking devices at the required angle



Part no.

TANDEM template

T65.1600.01

Accessories (order separately)

Ø2.5 mm drill bit

DB-2.5mm

Ø6 mm drill bit

DB-6mm

Tool set

T65.9000

Using the TANDEM template

- Bore rear fixing holes

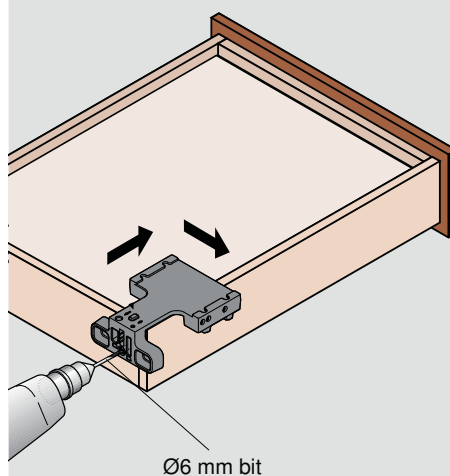

- Pre-bore holes for locking device screws

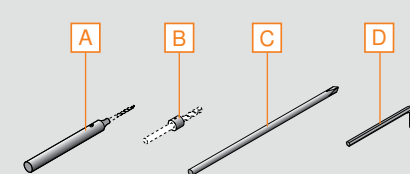
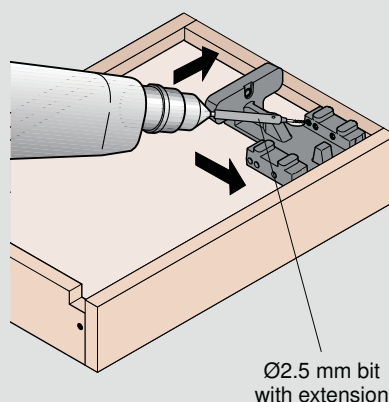

Tool set includes:

- A Ø2.5 mm drill bit extension
- B Ø6 mm stop collar
- C #2 Phillips screwdriver tip
- D Allen wrench

NOTE: Items NOT sold separately

Universal individual template



- For pre-boring TANDEM drawer runners
- Also used for marking/pre-boring other Blum drawer systems, AVENTOS locating pins, hinge mounting plates, BLUMOTION adapters, and TIP-ON adapters
- Calibrated scale for accurate setting

Set includes:

- Universal individual template
- Ø2.5 mm and Ø5 mm stop collars
- Allen wrench

Part no.

Universal individual template

65.1051.01

Cabinet profile template set



- Used for pre-boring holes for TANDEM drawer runners
- Also used for marking/pre-boring other Blum drawer systems, AVENTOS locating pins and hinge mounting plates

Part no.

Cabinet profile template

65.1000.01

Replacement template

65.1001.01

Ø2.5 mm drill bit

DB-2.5mm

Ø5 mm drill bit

DB-5mm

Components

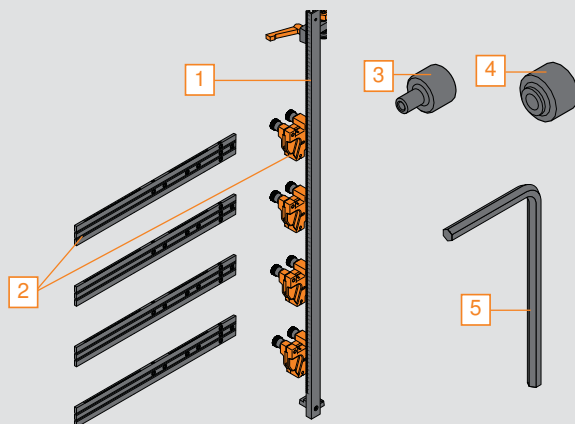

Set includes:

- 1 Rail, 1 meter long
- 2 Replacement template (qty 4)
- 3 Ø2.5 mm stop collar
- 4 Ø5 mm stop collar
- 5 Allen wrench

NOTE: ONLY the replacement template is sold separately

Additional options



ORGA-LINE

Most kitchen buyers want more storage space and organization in their kitchens. ORGA-LINE adjustable organization system is Blum's solution for optimizing storage space in drawers and can be customized to meet individual needs. No more looking for the lid to a pot or searching for a hand mixer. ORGA-LINE creates a place for everything in your kitchen.



SERVO-DRIVE

SERVO-DRIVE is an electrical opening assist for TANDEM and TANDEMBOX. Drawers open automatically with just a touch of the drawer front or with a light pull of the handle. This unique feature is based on an electrical drive unit that, once activated, opens the drawer for you.

Existing cabinets can be easily retrofitted with SERVO-DRIVE. No modifications to the drawer system are necessary when upgrading.

With SERVO-DRIVE, the drawer is not connected to the drive unit. This enables the drawer to be stopped at any position, providing you full control.



Part number index



Part no. Page no.

295.1000.21	43
295.3550.01	34
295.3700.21	35
295.3700.22	35
295.3750.01	34
295.5510	43
295.5520	43
295.5521	43
295.6400	35
295.6410	34
562F3050C	40
562F3810C	40
562F4570C	40
562F5330C	40
562H3050C	40
562H3810C	40
562H4570C	40
562H5330C	40
563.4570B	12, 29
563.5330B	12, 29
563F2290B10	16
563F3050B	16
563F3810B	16, 29
563F4570B	16, 29
563F5330B	16, 29
563H2290B10	14
563H3050B	14
563H3810B	14, 29
563H4570B	14, 29
563H5330B	14, 29
568R5330B	38
568R5337BB	36
568R5337BD	36
568R5337BF	36
569.6100B	18
569.6860B	18, 30
569.7620B	18
569A6100B	20
569A6860B	20, 30
569A7620B	20
569F4570B	20
569F5330B	20
569H4570B	18
569H5330B	18
606N	42

606P	42
606W	42
612TH	42
65.1000.01	45
65.1001.01	45
65.1051.01	45
65.2950.10	44
661.1300.HG	42
661.1450.HG	42
662.1150.HG	42
707N	42
BIT HOLDER	42
DB-2.5mm	44
DB-5mm	45
DB-6mm	44
FX4041	42
POZI DRIVER	42
POZI BIT #2x1	42
POZI BIT #2x2	42
SJ5312	42
T51.0801.20 R	33
T51.0801.20 L	33
T51.1700.04 R	40
T51.1700.04 L	40
T51.1801 R	33
T51.1801 L	33
T51.1801.20 R	33
T51.1801.20 L	33
T51.1901 R	32
T51.1901 L	32
T51.1901.20 R	32
T51.1901.20 L	32
T51.1901.PS R	32
T51.1901.PS L	32
T51.7000.01	28
T55.7150S	40
T55.908WR	41
T59.3570	43
T59.A5P0S	22
T59.T570	38, 43
T65.1600.01	44
T65.9000	44
Z10NA20UGUS	36
ZST.686TU01	26

Conversion chart

mm	inch	
1	1/32	.031
1.5	1/16	.063
2	3/32	.094
3	1/8	.125
4	5/32	.156
5	3/16	.188
5.5	7/32	.219
6	1/4	.25
7	9/32	.281
8	5/16	.313
9	11/32	.344
9.5	3/8	.375
10	13/32	.406
11	7/16	.438
12	15/32	.469
13	1/2	.5
13.5	17/32	.531
14	9/16	.563
15	19/32	.594
16	5/8	.625
17	21/32	.656
17.5	11/16	.688
18	23/32	.719
19	3/4	.75
20	25/32	.781
20.5	13/16	.813
21	27/32	.844
22	7/8	.875
23	29/32	.906
24	15/16	.938
24.5	31/32	.969
25.4	1	1

Notes





Blum, Inc. Headquarters, Stanley NC

Why choose Blum



Blum, Inc. is a leading manufacturer of functional hardware for the kitchen cabinet and commercial casework industries specializing in lift systems, concealed hinges and drawer runner systems. Virtually all of the hardware needed to assemble and make cabinets functional is available within the wide range of quality Blum products. Blum supports the U.S. market with a network of more than 150 dependable distributors, 40+ knowledgeable Blum sales representatives and an experienced customer service department.

Commitment to manufacturing in the U.S.

Blum manufactures many of its products in our 450,000 sq ft manufacturing, logistics and warehouse facility located in Stanley, North Carolina. Manufacturing closer to the customer allows Blum to react quickly to changing customer needs including unexpected surges in demand. Customer pickups and deliveries can be timed to better match their production schedules. Blum is committed to manufacturing in the U.S. for the U.S. market.



Product development at Blum considers all of the various customers who will come in contact with our products. With this "Global Customer Benefits" philosophy we strive to create advantages for all users.



Blum, Inc. is ISO 9001 certified which means that you are assured of consistent quality in every Blum product. What's more they exceed the requirements of ANSI/BHMA standards for cycle life, static load and self-closing performance.

Please visit blum.com for information on other Blum products.
LIT.TDM1100.07.13 © 2013 Blum, Inc. Printed in the USA.

Blum, Inc.
7733 Old Plank Rd.
Stanley, NC 28164
800-438-6788
blum.com



ISO 9001
Certified Quality
System

